

AUSTRALIAN CAPITAL TERRITORY

RACE AND SPORTS BOOKMAKING ACT 2001

DETERMINATION

INSTRUMENT NO. 267 OF 2001

Pursuant to Section 21(1) of the *Race and Sports Bookmaking Act 2001*, the Commission DETERMINES the following places to be sports bookmaking venues:-

the locations identified on the attached plans in respect of the east and west sides of the concourse level at Bruce Stadium.

Dated this 3rd day of September 2001

John Broome
Chairperson, ACT Gambling and Racing Commission

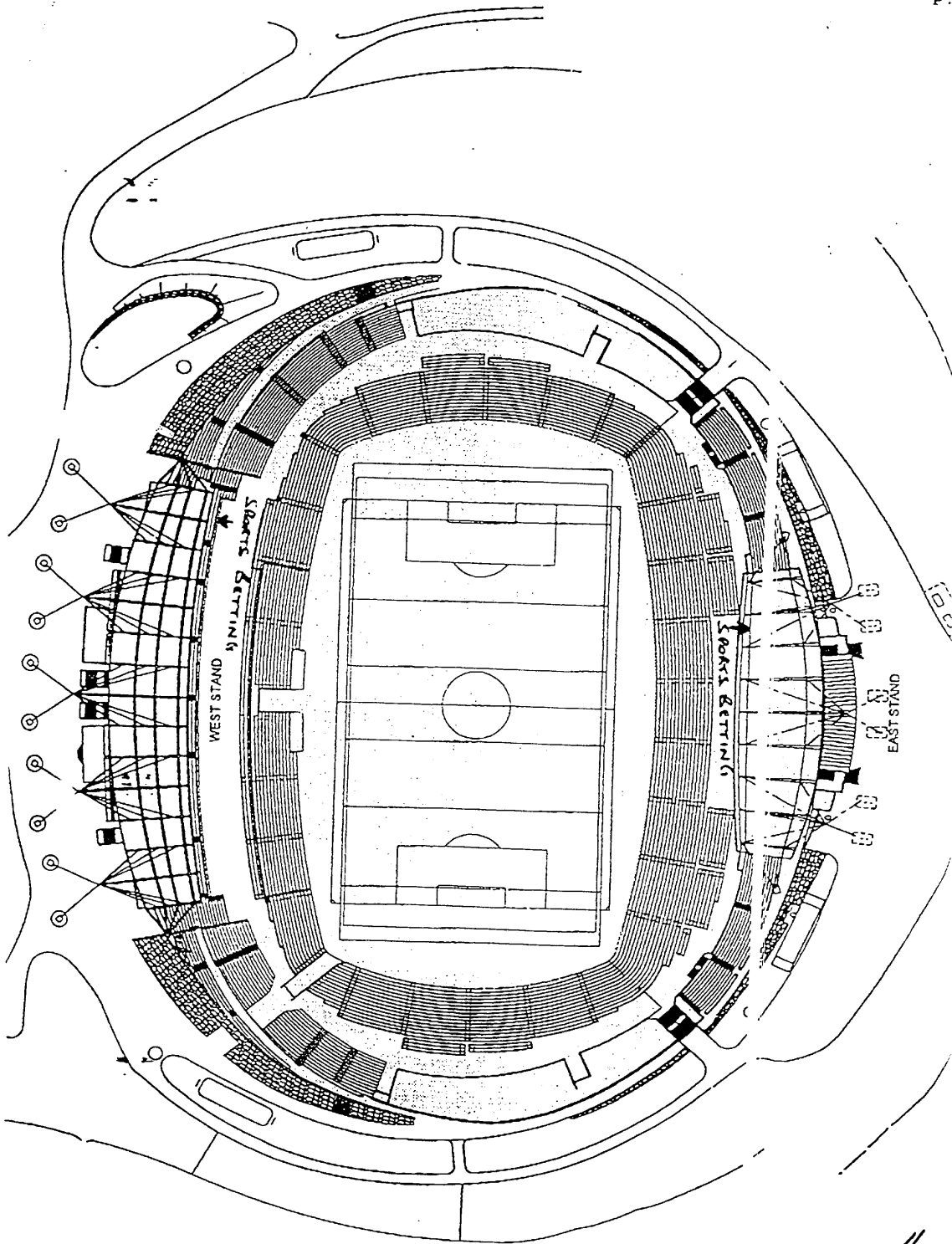

1	REVISIONS		
2			
3			
4			
5			
6			
7			
8			
9			
10			

BRUCE REDEVE
PHASE 1 - WEST SIDE



GENERAL NOTES:

1. ALL WORK TO BE IN ACCORDANCE WITH THE CURRENT EDITIONS OF THE NATIONAL BUILDING REGULATIONS AND THE ACT BUILDING REGULATIONS.
2. ALL WORK TO BE IN ACCORDANCE WITH THE CURRENT EDITIONS OF THE NATIONAL ELECTRICAL REGULATIONS AND THE ACT ELECTRICAL REGULATIONS.
3. ALL WORK TO BE IN ACCORDANCE WITH THE CURRENT EDITIONS OF THE NATIONAL PLUMBING REGULATIONS AND THE ACT PLUMBING REGULATIONS.
4. ALL WORK TO BE IN ACCORDANCE WITH THE CURRENT EDITIONS OF THE NATIONAL MECHANICAL REGULATIONS AND THE ACT MECHANICAL REGULATIONS.
5. ALL WORK TO BE IN ACCORDANCE WITH THE CURRENT EDITIONS OF THE NATIONAL FIRE REGULATIONS AND THE ACT FIRE REGULATIONS.
6. ALL WORK TO BE IN ACCORDANCE WITH THE CURRENT EDITIONS OF THE NATIONAL SAFETY REGULATIONS AND THE ACT SAFETY REGULATIONS.
7. ALL WORK TO BE IN ACCORDANCE WITH THE CURRENT EDITIONS OF THE NATIONAL ENVIRONMENTAL REGULATIONS AND THE ACT ENVIRONMENTAL REGULATIONS.
8. ALL WORK TO BE IN ACCORDANCE WITH THE CURRENT EDITIONS OF THE NATIONAL HEALTH REGULATIONS AND THE ACT HEALTH REGULATIONS.
9. ALL WORK TO BE IN ACCORDANCE WITH THE CURRENT EDITIONS OF THE NATIONAL EDUCATION REGULATIONS AND THE ACT EDUCATION REGULATIONS.
10. ALL WORK TO BE IN ACCORDANCE WITH THE CURRENT EDITIONS OF THE NATIONAL RECREATION REGULATIONS AND THE ACT RECREATION REGULATIONS.

PLAN LEVEL SECTION 2

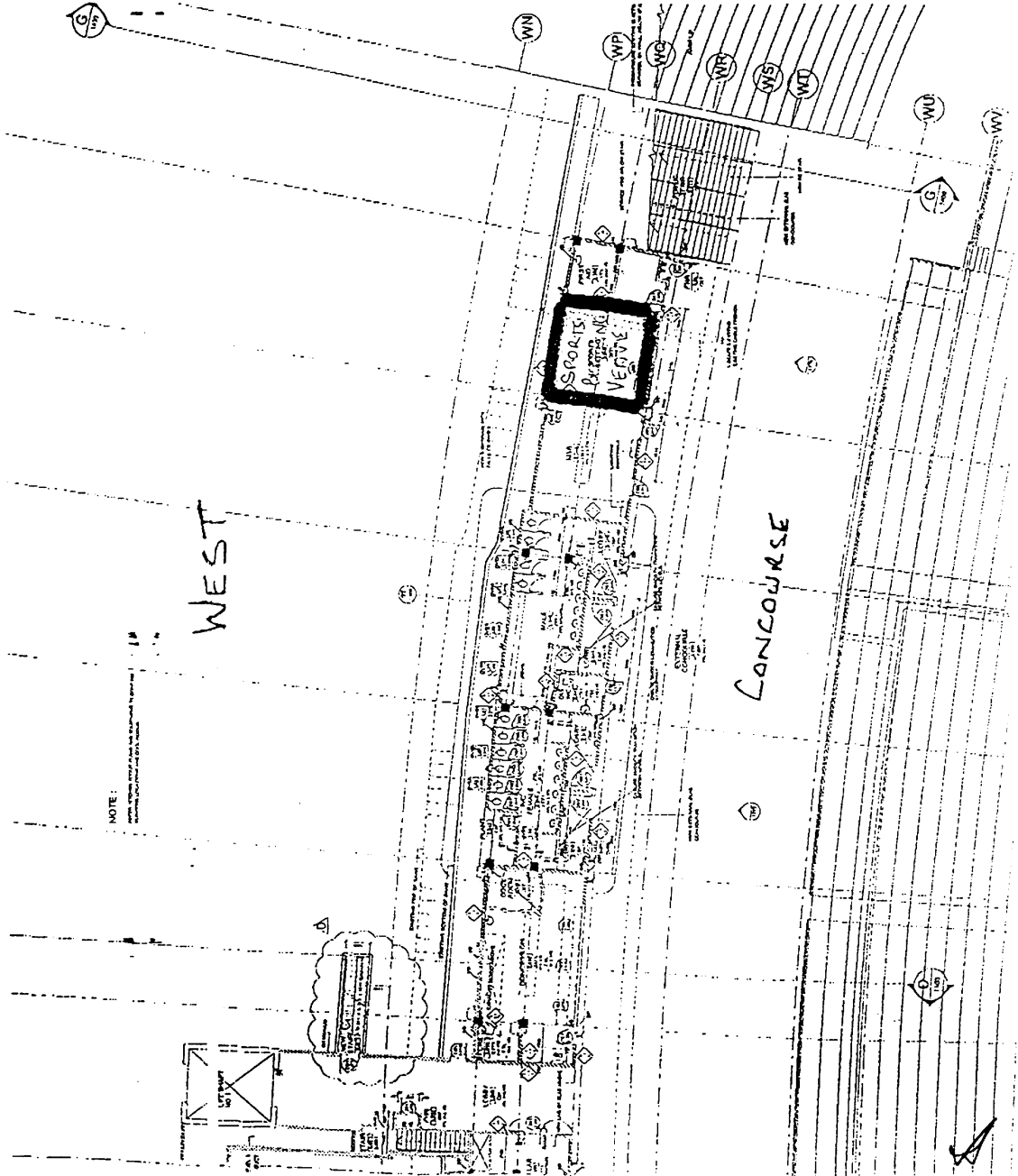

1	NAME OF CLIENT	ACT GOVERNMENT
2	PROJECT NAME	ACT GOVERNMENT OFFICE
3	PROJECT ADDRESS	ACT GOVERNMENT OFFICE
4	DATE OF DRAWING	1997/10/01
5	DRAWN BY	ACT GOVERNMENT OFFICE
6	CHECKED BY	ACT GOVERNMENT OFFICE

ACT GOVERNMENT OFFICE
REDEVELOPMENT
BRUCE ST.
REDEVELOPMENT
PART 7 - (ACT GOVERNMENT OFFICE)

ACT GOVERNMENT OFFICE
REDEVELOPMENT
BRUCE ST.
REDEVELOPMENT
PART 7 - (ACT GOVERNMENT OFFICE)

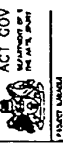

ACT GOVERNMENT OFFICE
REDEVELOPMENT
BRUCE ST.
REDEVELOPMENT
PART 7 - (ACT GOVERNMENT OFFICE)

ACT GOVERNMENT OFFICE
REDEVELOPMENT
BRUCE ST.
REDEVELOPMENT
PART 7 - (ACT GOVERNMENT OFFICE)

ACT GOVERNMENT OFFICE
REDEVELOPMENT
BRUCE ST.
REDEVELOPMENT
PART 7 - (ACT GOVERNMENT OFFICE)

ACT GOVERNMENT OFFICE
REDEVELOPMENT
BRUCE ST.
REDEVELOPMENT
PART 7 - (ACT GOVERNMENT OFFICE)

ACT GOVERNMENT OFFICE
REDEVELOPMENT
BRUCE ST.
REDEVELOPMENT
PART 7 - (ACT GOVERNMENT OFFICE)

ACT GOVERNMENT OFFICE
REDEVELOPMENT
BRUCE ST.
REDEVELOPMENT
PART 7 - (ACT GOVERNMENT OFFICE)

- 1. 100mm concrete slab
- 2. 100mm concrete slab
- 3. 100mm concrete slab
- 4. 100mm concrete slab
- 5. 100mm concrete slab
- 6. 100mm concrete slab
- 7. 100mm concrete slab
- 8. 100mm concrete slab
- 9. 100mm concrete slab
- 10. 100mm concrete slab
- 11. 100mm concrete slab
- 12. 100mm concrete slab
- 13. 100mm concrete slab
- 14. 100mm concrete slab
- 15. 100mm concrete slab
- 16. 100mm concrete slab
- 17. 100mm concrete slab
- 18. 100mm concrete slab
- 19. 100mm concrete slab
- 20. 100mm concrete slab
- 21. 100mm concrete slab
- 22. 100mm concrete slab
- 23. 100mm concrete slab
- 24. 100mm concrete slab
- 25. 100mm concrete slab
- 26. 100mm concrete slab
- 27. 100mm concrete slab
- 28. 100mm concrete slab
- 29. 100mm concrete slab
- 30. 100mm concrete slab
- 31. 100mm concrete slab
- 32. 100mm concrete slab
- 33. 100mm concrete slab
- 34. 100mm concrete slab
- 35. 100mm concrete slab
- 36. 100mm concrete slab
- 37. 100mm concrete slab
- 38. 100mm concrete slab
- 39. 100mm concrete slab
- 40. 100mm concrete slab
- 41. 100mm concrete slab
- 42. 100mm concrete slab
- 43. 100mm concrete slab
- 44. 100mm concrete slab
- 45. 100mm concrete slab
- 46. 100mm concrete slab
- 47. 100mm concrete slab
- 48. 100mm concrete slab
- 49. 100mm concrete slab
- 50. 100mm concrete slab

ACT GOVERNMENT OFFICE
REDEVELOPMENT
BRUCE ST.
REDEVELOPMENT
PART 7 - (ACT GOVERNMENT OFFICE)

ACT GOVERNMENT OFFICE
REDEVELOPMENT
BRUCE ST.
REDEVELOPMENT
PART 7 - (ACT GOVERNMENT OFFICE)

ACT GOVERNMENT OFFICE
REDEVELOPMENT
BRUCE ST.
REDEVELOPMENT
PART 7 - (ACT GOVERNMENT OFFICE)

ACT GOVERNMENT OFFICE
REDEVELOPMENT
BRUCE ST.
REDEVELOPMENT
PART 7 - (ACT GOVERNMENT OFFICE)

ACT GOVERNMENT OFFICE
REDEVELOPMENT
BRUCE ST.
REDEVELOPMENT
PART 7 - (ACT GOVERNMENT OFFICE)

ACT GOVERNMENT OFFICE
REDEVELOPMENT
BRUCE ST.
REDEVELOPMENT
PART 7 - (ACT GOVERNMENT OFFICE)

ACT GOVERNMENT OFFICE
REDEVELOPMENT
BRUCE ST.
REDEVELOPMENT
PART 7 - (ACT GOVERNMENT OFFICE)

ACT GOVERNMENT OFFICE
REDEVELOPMENT
BRUCE ST.
REDEVELOPMENT
PART 7 - (ACT GOVERNMENT OFFICE)

ACT GOVERNMENT OFFICE
REDEVELOPMENT
BRUCE ST.
REDEVELOPMENT
PART 7 - (ACT GOVERNMENT OFFICE)

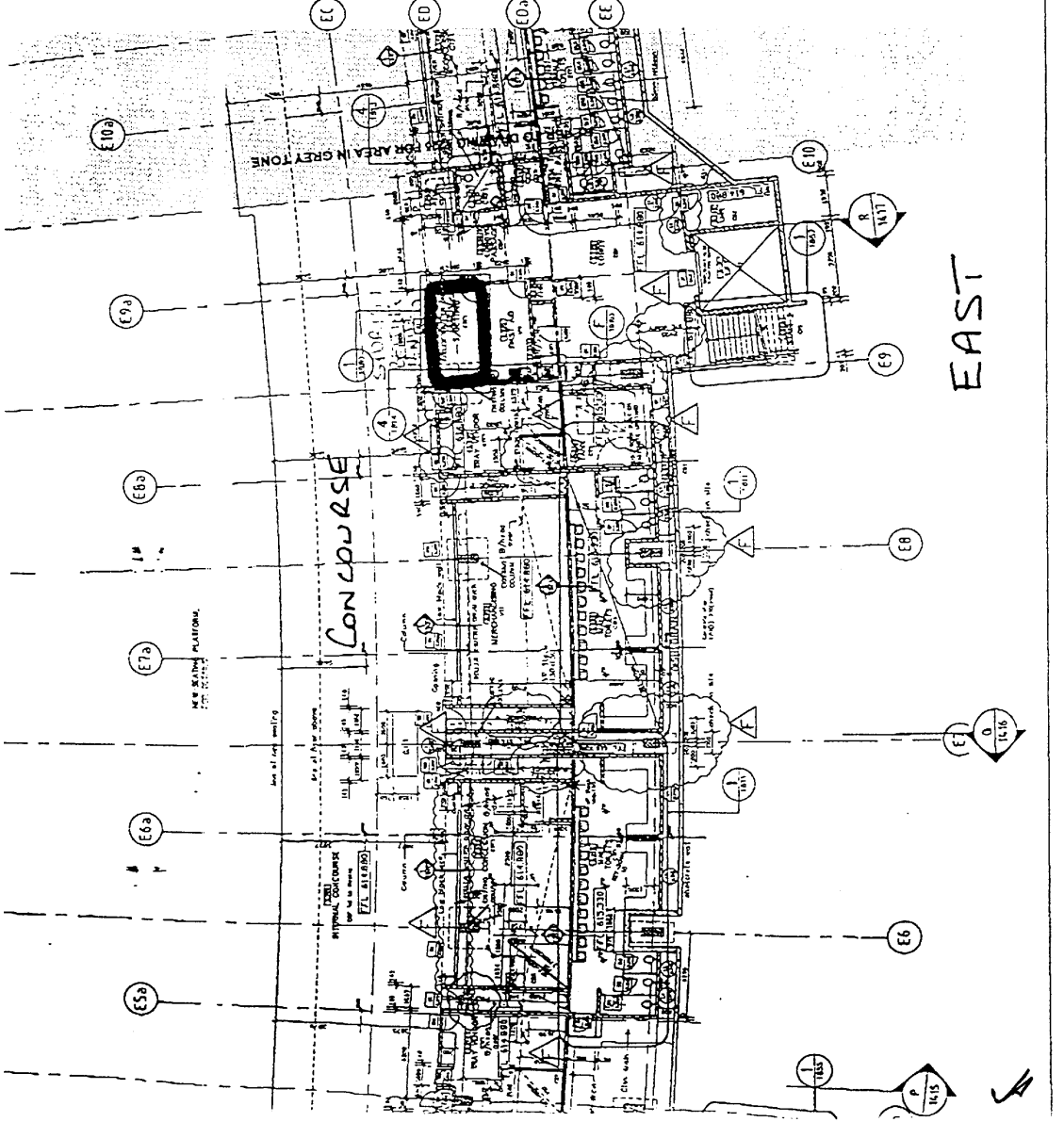

EAST