

No. S162, Wednesday 10 August 1994

INSTRUMENT NO. 15/94

**PUBLIC ROADS ACT 1902 OF THE STATE OF NEW SOUTH WALES
IN ITS APPLICATION TO THE AUSTRALIAN CAPITAL TERRITORY**

NOTIFICATION OF ROAD CLOSURE

Pursuant to section 20 of the Public Roads Act 1902 (NSW) in its application to the Territory, I close the part of the road described in the schedule to this Notice.

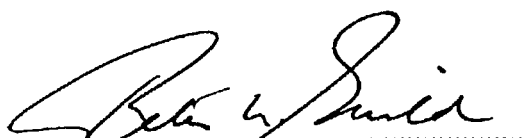

PETER NOBLE GUILD
Delegate of the Minister

DATE. 9 August 1994

SCHEDULE

All that land in the Australian Capital Territory, shown in a thick black line on the plan annexed hereto:

Plan No. 1: Part of the road known as Sydney Avenue in the Division of Barton in the District of Canberra Central.

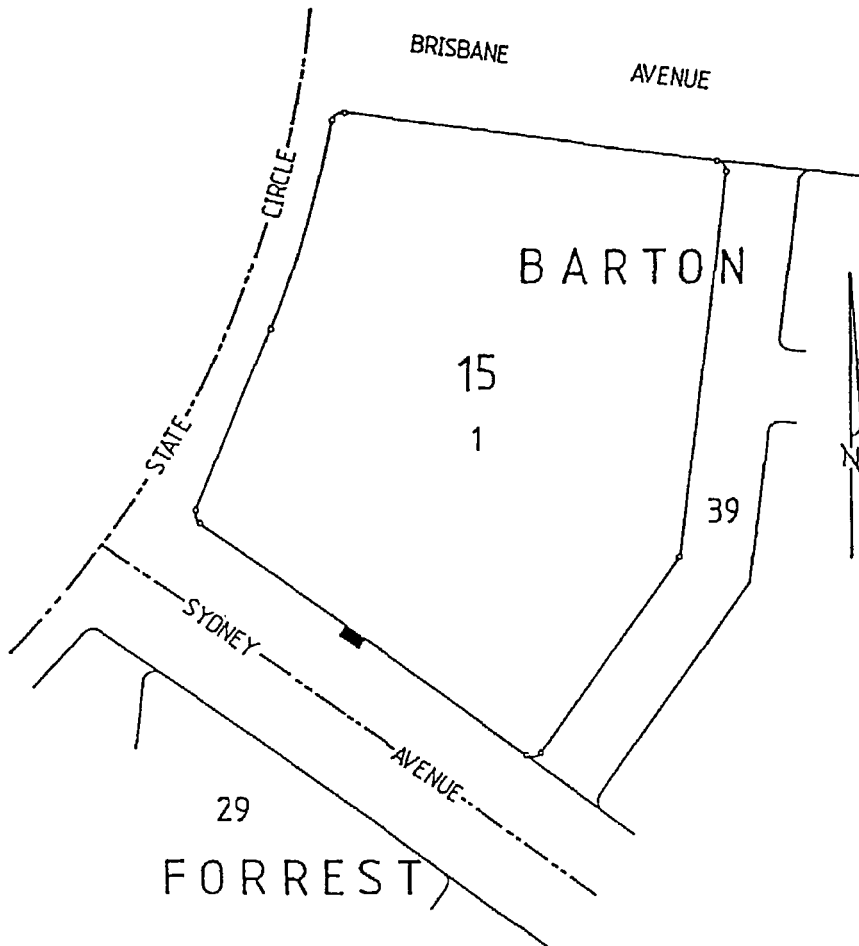

■ Denotes Road Closure
Division of BARTON

This is Plan Number One annexed to Instrument No. 15/94 signed on this ^{9th}
day of *August*, 1994.

.....
Delegate's Initials

NOTE : The closure is of part of a road necessary to facilitate a lease variation to Block 1
Section 15 Barton.