

Australian Capital Territory

Public Roads (City) (Intended Closure) Notice 2007 (No 2)*

R43/07

Notifiable instrument NI2007- 476

made under the

Public Roads Act 1902, section 19 (Notices of intention to close unnecessary road).

I notify that I am of the opinion that it is expedient to close the portions of the road reserves described below. Any interested person who wishes to object to these closures may do so within one month of the publication of this notice by setting out any objections in writing to:

The Minister for Planning
ACT Planning and Land Authority
GPO Box 1908
CANBERRA ACT 2601
Attention: Gerry Gagliardi

Bill Hirst
Chief Surveyor
Delegate of the Minister

17 December 2007

The portion of road reserve known as Darwin Place adjacent to Blocks 1, 2 and 23 Section 3; and a segment of the road reserve known as London Circuit adjacent to Blocks 2, 12 and part of Block 23 Section 3 in the Division of City, in the District of Canberra Central, as identified on the plan annexed hereto.

*Name amended under Legislation Act, s 60

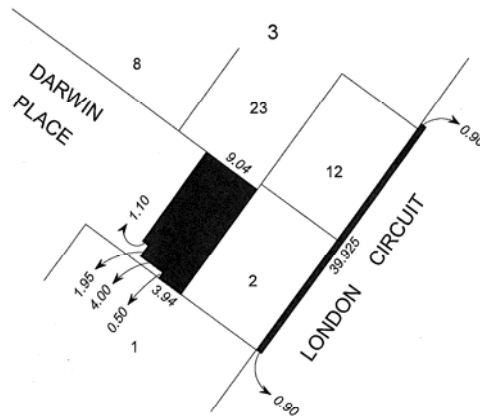

Note: Dimensions are in metres

 ROAD CLOSURE

DIVISION OF CITY

This is the plan annexed to Public Roads (City) (Intended Closure) Notice 2007 (No 4)
signed on this *Seventeenth* day of *December* 2007.

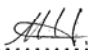
.....
Delegate's Initials