

Australian Capital Territory

## **Public Roads (City) Closure 2008 (No 1)**

**R03/08**

**Notifiable instrument NI2008-25**

made under the

**Public Roads Act 1902, section 20 (Closing of roads).**

---

I close the portion of the road reserve known as Darwin Place adjacent to Blocks 1, 2 and 23 Section 3; and a segment of the road reserve known as London Circuit adjacent to Blocks 2, 12 and 23 Section 3 in the Division of City, in the District of Canberra Central as identified on the plan annexed hereto.

Ron Jarman  
Acting Chief Surveyor  
Delegate of the Minister

23 January 2008

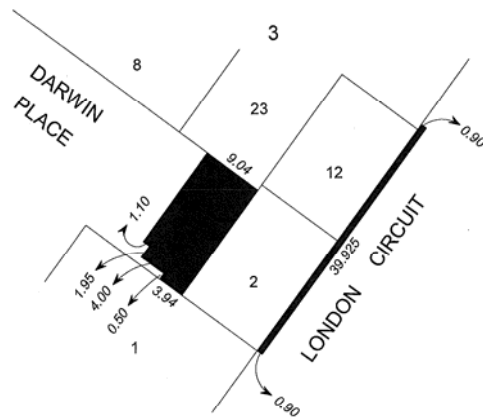

Note: Dimensions are in metres

ROAD CLOSURE

DIVISION OF CITY

This is the plan annexed to Public Roads (City) Closure Notice 2008 (No 1)  
signed on this *twenty third* day of *January* 2008.

*RA*  
.....  
Delegate's Initials