

# Planning and Development (Bus Shelter Master Plan) Approval 2009 (No 1)

Notifiable instrument NI2009—412

made under the

Planning and Development Regulation 2008, sch 1 s 1.90 (Minor public works)

---

**1 Name of instrument**

This instrument is the *Planning and Development (Bus Shelter Master Plan) Approval 2009 (No 1)*.

**2 Revocation**

The instrument revokes NI2008-419 notified 11 September 2008.

**3 Commencement**

This instrument commences on the day after it is notified.

**4 Approval**

Report for Advertising and Non Advertising Bus Shelters in the ACT Master Plan (Revision 4, July 2009) has been approved by the Planning and Land Authority.

The bus shelter master plan provides a plan for the location of bus shelters as detailed in Annexure A.

Neil Savery  
Chief Planning Executive  
Planning and Land Authority

31 August 2009



CLIENTS | PEOPLE | PERFORMANCE

## **Roads ACT**

### **Report for Advertising and Non Advertising Bus Shelters in the ACT**

**Master Plan Rev 4**

**July 2009**



# Contents

Executive Summary	1
1. Introduction	4
2. Proposed Bus Shelter Sites	6
2.1 General	6
2.2 Selection of Remaining Sites for Bus Shelters	7
2.3 Consistency of Shelter Type within Precincts and along Transport Corridors	8
3. Phasing of Shelter Construction	11
3.1 General	11
3.2 Phase 1	11
3.3 Phase 2	11
3.4 Phase 3	12
4. Shelter Design	13
5. Advertising	14
5.1 Size and Location of Advertising Panels	14
5.2 Movable Advertising Panels	14
5.3 Lighting of Advertising Panels	14
5.4 Advertising Content	14

## Table Index

Table 1	Proposed Shelter Distribution for Phase 2 and 3	6
---------	---	---

## Appendices

- A Bus Shelter Site Evaluation Criteria
- B Bus Shelter Justification
- C Bus Shelter Design
- D Bus Shelter Location Drawings



## Executive Summary

1. In December 2006, the ACT Government signed a contract with ADSHEL Street Furniture Pty Ltd for the supply, installation and maintenance of 241 bus shelters, at no cost to Government. These comprised:

- ▶ 133 illuminated advertising bus shelters;
- ▶ 108 illuminated non-advertising bus shelters.

The contract also includes:

- ▶ The relocation of approximately 76 existing shelters to sites nominated by the ACT Government to allow the erection of advertising or non advertising bus shelters in place of the existing shelters.

The erection and maintenance of all new shelters will be cost neutral to the ACT government with the advertising revenues by Adshel offsetting their costs of the infrastructure.

The contract maintenance period is 15 years. Construction of the bus shelters was to be originally undertaken over a period of 3 years. However the program is likely to be implemented over a much longer period.

Sites for a number of both the new shelters and the relocated shelters have not yet been finalised.

The principles guiding the rollout of the bus shelters are:

- ▶ All proposed shelter locations shall meet at least one of the Demand Criteria for the Installation of New Bus Shelters prepared by ACTPLA and Roads ACT (refer Appendix A);
- ▶ Advertising bus shelters are generally to be constructed in the City, Town Centres and on major transport routes connecting these centres. Construction of the shelters in these areas provides bus shelters on the most heavily used bus routes and, with high volumes of pedestrian and road traffic, will provide the best locations for advertising;
- ▶ Non advertising shelters will be located:
  - at group centres,
  - in suburban areas; and
  - in locations in the City, Town Centres and on major transport routes where advertising shelters are not proposed but where a shelter is justified and a new shelter is desirable (e.g. for consistency of structure types within an area).

This Masterplan provides details of the shelters to be constructed under the contract with ADSHEL Street Furniture Pty Ltd. Under the relevant legislation, shelters covered by this Masterplan do not require individual Development Approval from ACTPLA.

The purpose of this master plan is:

- ▶ To highlight how Phase 1 was executed.
- ▶ To summarise ADSHEL's current proposals for the project;
- ▶ To demonstrate how a consistent design solution will be achieved across nominated travel routes and precincts throughout the rollout;



- ▶ To outline how the delivery of the bus shelters is to be phased;
- ▶ To outline how sites not yet identified are to be selected for inclusion in the project.

2. As part of Phase 1, Adshel constructed 35 advertising shelters and 18 non-advertising shelters which have been focused around the town centres of Belconnen, Woden, City, Tuggeranong and Barton. Adshel also relocated two concrete bunkers to secondary sites in Mawson and Warramanga.

To date, Roads ACT and Adshel have identified an additional 174 possible bus stops for construction of the remaining 188 new advertising and non-advertising shelters. Roads ACT have also identified 46 sites of the potential 74 sites required to receive a relocated existing shelter in Phases 2 and 3.

In Phase 2 and 3 of the project at least an additional 14 sites will need to be identified to receive a new shelter, however it is likely that more sites will need to be considered due to some of the selected sites failing to meet Roads ACT and Adshel requirements. Given there is some degree of uncertainty as to which sites will be selected to receive a new Adshel shelter it is difficult to determine the number of sites required to receive a relocated shelter. However it is known that as part of Phase 2 and 3 additional sites will need to be determined to receive a relocated shelter.

In Phase 2 and 3 of the project approximately 28 more sites will be identified by Roads ACT to receive an existing relocated shelter in these phases. It is also possible that additional sites may need to be identified to receive an advertising or non-advertising Adshel shelter as the currently proposed site list is not definitive and some sites may not meet Roads ACT requirements.

Any additional sites still to be identified will be selected by Roads ACT in consultation with Adshel from:

- ▶ Sites requested by the public;
- ▶ Sites suggested by ACTION based on passenger numbers;
- ▶ Sites requested by the Adshel Street Furniture Pty Ltd based on commercial criteria;
- ▶ Sites requested by Roads ACT.

An important objective of the project is to achieve an acceptable aesthetic outcome through providing a consistency in shelter types within different precincts within Canberra and along the major transport routes.

3. Construction of the bus shelters will be undertaken in three phases, as follows:

- ▶ Phase 1 completed in March 2008 involved the construction of 53 new bus shelters.
- ▶ Phase 2 reduced roll out, to be completed by mid 2009, involves the construction of 43 new Adshel shelters. Where sites to receive a new shelter already have a shelter, the existing shelter will be relocated to a secondary site within the ACT. Phase 2 will thus result in a net benefit of 43 shelters on sites currently without shelters.
- ▶ Phase 2 remaining shelters, expected to commence in 2010, involves the construction of 55 new Adshel shelters. Where sites to receive a new shelter already have a shelter, the existing shelter will be relocated to a secondary site within the ACT. Phase 2 remaining will thus result in a net benefit of 55 shelters on sites currently without shelters.
- ▶ Phase 3 to be completed at some future time involves the installation of 90 new Adshel shelters. Where sites to receive a new shelter already have a shelter, the existing shelter will be relocated to a



secondary site within the ACT. Phase 3 will thus result in a net benefit of 90 shelters on sites currently without shelters.

4. All new shelters will be of the Adshel EVO Mk III type. EVO Mk III is a minor revision of the EVO Mk II which was originally proposed in the contract. The minor variations include an extra support under the ad panel to help prevent vandalism as well as slightly longer legs for ease of installation on steeper terrain. Refer to Appendix C for plans and photographs of the proposed structures.



# 1. Introduction

In December 2006, the ACT Government signed a contract with Adshel Street Furniture Pty Ltd for the supply, installation and maintenance of 241 bus shelters at no cost to Government. These include:

- 133 illuminated advertising bus shelters;
- 108 illuminated non-advertising bus shelters.

The contract also includes the relocation of roughly 76 existing shelters throughout all three phases to sites nominated by the ACT Government to allow the erection of advertising or non advertising bus shelters in place of the existing shelters.

The erection and maintenance of all new shelters will be cost neutral to the ACT government with the advertising revenues by Adshel offsetting their costs of the infrastructure.

The contract maintenance period is 15 years. Construction of the bus shelters was to be originally undertaken over a period of 3 years. However the program is likely to be implemented over a much longer period.

Sites for a number of both the new shelters and the relocated shelters have not yet been finalised.

The principles guiding the rollout of the bus shelters are:

- All proposed shelter locations shall meet at least one of the Demand Criteria for the Installation of New Bus Shelters prepared by ACTPLA and Roads ACT (refer Appendix A);
- Advertising bus shelters are generally to be constructed in the City, Town Centres and on major transport routes connecting these centres. Construction of the shelters in these areas provides bus shelters on the most heavily used bus routes and, with high volumes of pedestrian and road traffic, will provide the best locations for advertising;
- Non advertising shelters will be located:
  - at group centres,
  - in suburban areas; and
  - in locations in the City, Town Centres and on major transport routes where advertising shelters are not proposed but where a shelter is justified and a new shelter is desirable (e.g. for consistency of structure types within an area).

This Masterplan provides details of the shelters to be constructed under the contract with Adshel Street Furniture Pty Ltd. Under the relevant legislation, shelters covered by this Masterplan do not require individual Development Approval from ACTPLA.

The purpose of this master plan is:

- To highlight how Phase 1 was executed.
- To summarise Adshel's current proposals for the project;
- To demonstrate how a consistent design solution will be achieved across nominated travel routes and precincts throughout the rollout;
- To outline how the delivery of the bus shelters is to be phased;



- ▶ To outline how sites not yet identified are to be selected for inclusion in the project.

The details included in this masterplan provide an indication of the objective of the project. However it is expected that some variation in the following may take place:

- ▶ Shelter locations have not been finalised and may vary as more research is carried out into the proposed sites.
- ▶ Phasing is subject to change dependent on approvals.
- ▶ Shelters that have been approved as ad sites which are not utilised by Adshel for advertising but are still deemed to require a new shelter may be used as non ad sites without further approval by ACTPLA.





## 2. Proposed Bus Shelter Sites

### 2.1 General

Under the contract Adshel is required to construct 241 new shelters at sites around the ACT. To date, 230 bus stops have been identified with the potential to receive a new Adshel shelter; one stop nominated in the inner south is proposed to have double shelters. The sites identified for new shelters may result in approximately 76 existing shelters throughout Phase 1, 2 and 3 requiring relocation to sites nominated by Roads ACT across Canberra.

Phase 1 involved the construction of 53 of these new Adshel shelters and two concrete bunker relocations.

The distribution of the remaining 174 identified sites for Adshel shelters in Phase 2 and 3 is summarised in Table 1.

**Table 1 Proposed Shelter Distribution for Phase 2 and 3**

Location	Total Number of Sites
Gungahlin Town Centre	3
Gungahlin Suburban	22
Belconnen Town Centre	5
Belconnen Suburban	32
City/Inner North	38
Inner South	30
Weston Creek	5
Woden Town Centre	5
Woden Suburban	11
Tuggeranong Town Centre	5
Tuggeranong Suburban	18
TOTALS	169

The project concentrates on the City, Town centres and Group Centres and on major transport routes connecting these activity nodes (i.e. high activity areas which provide the best return for both advertisers and bus users).

The first phase has been executed with an aim to a spread of shelters with a focus on the City and Town Centres.

The second phase focuses on the city and busy transportation routes within Canberra. While the third phase is developed to provide shelters to well used suburban stops.



Bus shelter proposals for the currently identified 174 possible new Adshel shelters to be located on the 173 sites described in table 1 and 46 identified relocation sites for Phase 2 and 3 are shown in the drawings in Appendix D.

Thus far 174 advertising and non advertising bus shelters (including the one double shelters) have been identified by Roads ACT and Adshel. These are currently broken into 109 proposed advertising and 68 non advertising shelters; this includes the one double shelter stop, located in the inner south with one advertising and one non advertising shelter. Under the contract for Phase 2 and 3 Adshel are required to build 98 advertising and 90 non advertising shelters. This results in an excess of advertising sites and a short fall of non-advertising sites. While advertising sites can be converted to non advertising sites without further approval these sites were selected by Adshel and may not represent Roads ACT's needs for a non advertising site. Therefore it is possible that more sites for either advertising or non advertising shelters may need to be selected even if an excess of the other exists.

Furthermore 74 Phase 2 and 3 sites with an existing shelter have been flagged to potentially receive a new shelter. As part of the contract bus stops with existing shelters can receive a new shelter for the following reasons:

- ▶ Adshel request the site for Advertising;
- ▶ The replacement of this shelter creates a uniform and aesthetically pleasing precinct.

Roads ACT have currently identified 46 sites suitable to receive a relocated shelter and are in the process of determining up to 28 more sites.

All bus stops to be erected as part of the project must comply with at least one of the criteria developed by Roads ACT and ACTPLA (refer Appendix A). In addition Roads ACT will carry out checks on all sites in Phases 2 and 3 to confirm that the community is in fact using them.

## **2.2 Selection of Remaining Sites for Bus Shelters**

The sites to receive a relocated shelter still to be identified and any additional advertising or non advertising sites required due to the failure of any of the identified sites to meet ACTPLA approval will be selected by Roads ACT in consultation with Adshel from:

- ▶ Sites requested by the public;
- ▶ Sites suggested by ACTION based on passenger numbers;
- ▶ Sites requested by the Adshel Street Furniture Pty Ltd based on commercial criteria;
- ▶ Sites requested by Roads ACT.

Under the current legislation, sites that Roads ACT nominates to receive a relocated shelter do not require further approval.

However any sites not included in this Masterplan but which are later identified for erection of an Adshel shelter will first be reviewed to ensure consistency with at least one of the criteria in Appendix A. They will then need to be approved by ACTPLA through the usual Development Applications process.



## **2.3 Consistency of Shelter Type within Precincts and along Transport Corridors**

An important objective of the project is to achieve an acceptable aesthetic outcome through providing a consistency in shelter types within different precincts within Canberra and along the major transport routes.

The location of new shelters within precincts and along major transport routes within Canberra is discussed in the following sections.

### **2.3.1 Precincts**

In this report, precincts are defined as areas within Canberra that have a homogeneous character. They include the City, Town Centres and other residential or business areas whose boundaries are reasonably well defined. These precincts are generally major bus and general traffic generators.

#### ***City/Inner North***

There are a number of existing shelters in the city, in particular in the vicinity of the bus interchange.

In Phase 1, 13 new shelters were installed in locations throughout the City and Inner north. In Phase 2 and 3, 38 new shelters are proposed on sites currently with and without shelters throughout the city.

At the completion of Phase 3 most of the existing shelters in the City and inner north will have been replaced with the new structure type. The upgrading of most of these structures will create a sense of uniformity and modernisation throughout the city while continuing to provide commuters in this busy transport area with protection. These shelters are also ideal for advertising exposure to both pedestrian and passing traffic.

At the completion of the project existing shelters will be left in several locations throughout the city; these are as follows:

- ▶ At the interchange (existing steel and glass structures);
- ▶ Several concrete bunkers scattered through the suburbs of the Inner North;
- ▶ Shelters in the city which due to their location are not utilised by commuters and do not provide good advertising opportunities.

For consistency along Northbourne Ave all existing shelters are proposed to be upgraded as part of Phase 2.

#### ***Barton/Forrest***

Phase 1 saw the installation of five new shelters within Barton and Forrest. Following on from the work in Phase 1, Phase 2 focuses heavily on upgrading shelters in the employment node of Barton and Forrest. This area generates a large number of commuters from the surrounding offices. Additional shelters are therefore warranted and, because of the high profile nature of the area it is considered desirable to maintain a consistent shelter type in the area. By the end of Phase 2 all existing shelters in this zone will be replaced with the exception of one shelter on National Circuit near Kings Avenue, one special shelter on Sydney Avenue, one shelter on Empire Circuit and those existing shelters on NCA land and roads within the Parliamentary Zone.



### ***Town Centres***

At the completion of the project, it is proposed that, in all Town centres, virtually all concrete shelters will be replaced with new shelters.

#### **- Belconnen Town Centre**

There is only one concrete shelter in the Belconnen Town Centre. During Phase 1 five new shelters were constructed in the Belconnen Town Centre. The refurbishment of the Belconnen bus interchange beginning with the Cohen Street Extension has significantly changed bus patterns within this area. Five new advertising shelters have been installed as part of the Cohen Street Extension project, at this stage there are no more shelters planned for the Belconnen Town Centre. This will leave one concrete shelter in the Belconnen Town Centre.

#### **- Woden Town Centre**

There are four existing shelters in the Woden Town Centre. One existing shelter was relocated in Phase 1. Another two shelters will also be replaced in Phase 2 and 3, leaving only one special shelter on Corinna Street in the town centre. Apart from replacing the existing shelters three shelters will be constructed at new sites within the Town Centre. At the completion of the project there will be no concrete bunkers in the Woden town centre.

#### **- Tuggeranong Town Centre**

Other than the bus interchange there is only one existing bus shelter (concrete structure).

In Phase 1, five new shelters on sites currently without shelters were built.

Phase 2 and 3 shall see the addition of five more shelters including the replacement of the existing concrete bunker within the Tuggeranong Town Centre.

At the completion of Phase 3 all sites within the Tuggeranong town centre will be of the new structure type.

#### **- Gungahlin Town Centre**

Gungahlin Town Centre did not have any existing concrete shelters prior to the commencement of the Adshel contract. One advertising shelter was built in Gungahlin Town Centre as part of Phase 1. Phase 2 and 3 will see the addition of three more advertising and non advertising shelters within the Gungahlin Town Centre.

### ***Group Centres***

In general non advertising shelters have been proposed for Group Centres throughout the ACT where they are justified. Phase 2 and 3 will see the construction of 27 of these sites.

### **2.3.2 Transport Corridors**

Transport corridors are the road links between major centres of activity and are generally arterial roads carrying high bus and general traffic volumes.

#### ***Northbourne Ave***

This is a major route for entry to and exit from the City. There are a number of concrete “bunker” shelters along Northbourne Ave. Under the project it is proposed that all shelters along Northbourne Ave will be



replaced with the new shelter type. Furthermore several new shelters will be constructed at stops along this busy route which do not currently have a shelter.

#### ***Drakeford Dr***

There are two existing concrete shelters on Drakeford Dr.

In Phase 1 no new shelters were built.

In Phase 2 one new shelter on a site currently without a shelter is proposed.

In Phase 3, two new shelters are proposed, one of which will replace the existing concrete shelter in Kambah. Very few shelters are proposed along Drakeford Dr due to the low usage by passengers.

At the completion of the project only one concrete shelter will remain although due to the low numbers of new shelters it is not deemed important to replace this shelter with the new type.

#### ***Athllon Dr***

There are five existing concrete shelters on Athllon Dr.

In Phase 1 one new shelter was built.

In Phase 2 and 3, four new shelters are proposed. These shelters will replace existing concrete shelters along Athllon Dr. There is currently no justification for replacing the remaining concrete shelter along this route.

#### ***Canberra Ave***

There are two existing concrete shelters on Canberra Ave.

In Phase 1 two new shelters have been built in Forrest.

In Phase 2, a further two more new shelters are proposed on Canberra Ave in Narrabundah.

At the completion of Phase 2 there will be two concrete shelters and four shelters of the new structure type.

The shelters are located in pairs spread a minimum of 900m apart along Canberra Ave with the two concrete bunkers located in the industrial area of Fyshwick.

#### ***Southern Cross Drive***

At the commencement of the contract with Adshel there were six existing shelters along Southern Cross Drive.

In Phase 1 one new shelter was constructed at Holt (near the Kippax Centre)

Phase 2 does not propose any new shelters along this route.

In Phase 3 there are five proposed shelters to replace four existing concrete bunkers.

At the completion of Phase 3 there will be one remaining concrete bunker in Florey.

## 3. Phasing of Shelter Construction

### 3.1 General

Construction of the 241 bus shelters is being undertaken in three phases. The current program is as follows:

- ▶ Phase 1 completed in March 2008 involved the construction of 53 new bus shelters.
- ▶ Phase 2 reduced roll out to be completed by mid 2009 involves the construction of 43 new Adshel shelters. Where sites to receive a new shelter already have a shelter, the existing shelter will be relocated to a secondary site within the ACT. Phase 2 will thus result in a net benefit of 43 shelters on sites currently without shelters.
- ▶ Phase 2 remaining shelters, expected to commence in 2010, involves the construction of 55 new Adshel shelters. Where sites to receive a new shelter already have a shelter, the existing shelter will be relocated to a secondary site within the ACT. Phase 2 remaining will thus result in a net benefit of 55 shelters on sites currently without shelters.
- ▶ Phase 3 to be completed at some future time involves the installation of 90 new Adshel shelters. Where sites to receive a new shelter already have a shelter, the existing shelter will be relocated to a secondary site within the ACT. Phase 3 will thus result in a net benefit of 90 shelters on sites currently without shelters.

### 3.2 Phase 1

Phase 1 works consisted of:

- ▶ 35 new advertising bus shelters;
- ▶ 18 new non advertising bus shelters;
- ▶ Relocation of two existing shelters to sites previously without shelters.

Phase 1 aimed to provide a variety of locations with new bus shelters while achieving a large commercial exposure at the start of the project.

The Phase 1 works were therefore concentrated on the city centre, inner north, inner south in the vicinity of Barton and the high-density areas of Woden, Belconnen and Tuggeranong Town Centres.

To make the project commercially viable from the start, Phase 1 had a ratio of approximately 2:1 advertising shelters to non-advertising shelters, which was in accordance with the contract.

All bus stops erected in Phase 1 of the project were evaluated against the criteria developed by Roads ACT and ACTPLA (refer Appendix A) and were found to comply with at least one of the criteria listed. Furthermore each shelter passed ACTPLA's approval rating process.

### 3.3 Phase 2

Phase 2 works will consist of:

- ▶ 52 new advertising bus shelters;
- ▶ 46 new non advertising bus shelters (the location of these shelters has not yet been determined);



- Relocation of approximately 34 existing shelters to sites currently without shelters.

Phase 2 works are concentrated in the employment hub of Barton, City/inner north area, in particular on Northbourne Ave and to a lesser degree on the suburban areas of Belconnen, Woden and Gungahlin.

All sites to have a shelter erected in Phase 2 of the project have been evaluated against the criteria developed by Roads ACT and ACTPLA (refer Appendix A) and have been found to comply with at least one of the criteria listed. The justification for each shelter in Phase 2 is included in the shelter details in Appendix B.

### **3.4 Phase 3**

Phase 3 works will consist of:

- 46 new advertising bus shelters;
- 44 new non advertising bus shelters (the location of these shelters has not yet been determined);
- Relocation of approximately 40 existing shelters to sites currently without shelters.

Phase 3 concentrates heavily on suburban areas throughout Canberra.

All sites to be erected in Phase 3 have been evaluated against the criteria developed by Roads ACT and ACTPLA (refer to Appendix A) and have been found to comply with at least one of the criteria listed. The justification for each shelter in Phase 3 is included in the shelter details in Appendix B.



## 4. Shelter Design

All new shelters will be of the Adshel EVO Mk III type. Refer to Appendix C for plans and photographs of the proposed structures, the EVO Mk III technical drawing shows one arm rest in the centre of the seat, in the ACT these shelters will be installed with two arm rests.

The contract between Adshel and TAMS states that the shelter type to be installed is Adshel EVO Mk II. Throughout the installation process the EVO Mk II shelters have been refined to help prevent vandalism of the advertising panel. The new design is EVO Mk III and includes an extra leg on the advertising panel. The other minor difference between the EVO Mk II and EVO Mk III is the leg lengths are slightly longer to allow easier installation on steep terrain. Otherwise the EVO Mk II and EVO Mk III are essentially the same.

It is proposed that a number of existing shelters (mainly of the concrete bunker type) will be relocated to allow for advertising shelters to be erected on these sites. Sites on which existing shelters will be relocated are shown in the drawings in Appendix D.





## 5. Advertising

Any advertising on bus shelters erected under this contract will conform to the signage requirements outlined in the Authority's ACT Bus and Taxi Shelter Signage Master Plan, 19 April 2006.

### 5.1 Size and Location of Advertising Panels

Advertising panels shall be located only on bus shelters and shall have maximum dimensions of 1.8m by 1.2m except in Designated Areas where panel dimensions shall be in accordance with the National Capital Plan. Advertising panels may be dual sided but shall only be located at the departure end of bus shelters.

### 5.2 Movable Advertising Panels

This plan allows for movable advertising panels of the dimensions listed above in all localities.

### 5.3 Lighting of Advertising Panels

All advertising panels will be lit at night using the street light network and light overspill will illuminate the surrounds and internal space of the structure.

### 5.4 Advertising Content

All advertising as a minimum must comply with the Advertising Standard adopted by the Australian Association of National Advertisers (AANA) (the Advertising Standard).

Advertisements of and/or in relation to the products and matters that are listed below shall be prohibited:

- a) Advertisements for cigarettes or tobacco products,
- b) Political advertisements,
- c) Religious advertisements,
- d) Advertisements that are false or misleading,
- e) Advertisements which promote unlawful or illegal goods, services or activities or which are otherwise unlawful,
- f) Advertising material likely to offend against community taste and standards,
- g) Advertising material determined by the Territory as offensive, obscene or causing damage,
- h) Other matters which may be determined by the Territory from time to time and notified to the Contractor in writing.



## Appendix A

# Bus Shelter Site Evaluation Criteria



## Demand Criteria\* for the Installation of New Bus Shelters

Before granting of an endorsement for a new bus shelter not replacing an existing bus shelter, the Department of Territory and Municipal Services must be satisfied that one or more of the following demand criteria have been met.

The site of the proposed bus shelter:

1. Is an existing bus stop with an average of 8 or more people using the stop per hour during peak periods;
2. Is located at a local centre;
3. Is within 200m walking distance of aged care accommodation;
4. Is within 400m walking distance of a primary school, high school, college or university;
5. Is located within walking distance of a significant node of employment outside Civic, town or group centres;
6. Will service a tourist facility outside Civic, town or group centres;
7. Is located within walking distance of a significant community facility;
8. Will service increased density development.
9. In exceptional circumstances approval may be given by the Department for the location of shelters on sites not complying with the above criteria but which are considered necessary and justifiable for meeting specific or special community needs.

Bus Shelters with advertising shall not be randomly located to respond to visibility and commercial considerations. They shall only be approved where there is a clear need by the community or consistency along a road or within a town centre can be demonstrated.

\*Roads ACT in conjunction with ACTION and ACTPLA will review these criteria during the course of this project and revise them as necessary based on the experience gained in applying the criteria in practise.



## Appendix B

# Bus Shelter Justification

PHASE 2 SHELTER LOCATIONS

Shelters Installed in Reduced Rollout

Phase	Ad	Non-Ad	Existing Shelter	Relocation	RDG Drg #	Block	Section	Bus Stop Number	Location	Region	Request Type	GHD Comments
2			None	1		16	877	1002	E/S Drumsten st N/O Elletston Ave	Isabella Plains	Public request	Peak hour volume
2			None	1		8	883	1008	E/S Ellerston Ave N/O Galloway St	Isabella Plains	Public request	Peak hour volume
2		1	None			35	610	1100	W/S Scantlebury Cres S/O Lienhop St	Theodore	Public request	Peak hour volume
2		1	None					1174	Sternberg Cres	Tuggeranong	Public request	Peak hour Volume
2			None	1		40	103	1274	N/S Barritt St W/O Bacchus Cct	Kambah	Action request	Peak hour volume
2			None	1				1275	Barritt St	Kambah	Public request	Peak hour volume
2			None	1				1276	Barritt St	Kambah	Public request	Peak hour volume
2			None	1		3	161	1277	S/S Barritt St E/O Bacchus Cct	Kambah	Action request	Peak hour volume
2			None	1		25	5	1445	W/S Charleston Street N/O Scratchley Pl	Monash	Public request	Peak hour volume
2			None	1				1577	Duggan St	Calwell	Public request	Peak hour volume
2			None	1				1668	Duggan St	Calwell	Public request	Peak hour volume
2		1	None			1	77	2009	W/S Throssel St N/O Storey St	Curtin	Public request	Peak hour volume
2	1		1		35	1	1	2032	Melrose Dr., Lyons, Adjacent to The Church of Christ	Woden		Walk to employment node/community facitlly
2			None	1		2	13	2146	S/S Hindmarsh Drive, Rivett W/O Bangalay Cres	Weston	Public request	Peak hour volume
2	1		None					2259	National Cct	Barton	Government Request	Replacement of Broken shelter
2		1	None					2373	Wentworth Ave	Kingston	Public request	Peak hour volume
2			None	1		15	45	2394	E/S Mulley st N/O Blackwood Tce	Holder	Public request	Walk to community facility
2	1		None		69	6	39	2678	N/S Canberra Ave E/O Nyrang St	Narrabundah		At Local Centre
2	1		None		71	21	1	2680	S/S Canberra Ave W/O Nyrang St	Narrabundah		At Local Centre
2			None	1		11	24	3385	E/S Fawknser st N/O Elouera St	Braddon	Public request	Within 400m of school/walk to community facility
2		1	None					4030	Maribyrnong Avenue	Kaleen	GHD Suggestion	Peak hour Volume
2		1	None			1	9	4031	E/S Maribymong Avenue S/O Yarra St	Kaleen	Public request	Peak hour volume
2		1	None			6	15	4168	E/S Alfred Hill Dr S/O Levery Pl	Melba	Public request	Volume Check reveals reasonable volumes 7 passengers in Peak hour
2		1	None			1	14	4170	S/S Alpen St W/O Clifford Cres	Melba	Public request	Peak hour volume
2	1		1					4551	Northbourne Ave, Dickson southbound south of Antill	North Canberra		At Local Centre
2	1		1		127	26	52	4552	Northbourne Ave. Lyneham northbound south of Mouat St	North Canberra		At Local Centre,
2	1		1		128	7	33	4553	Northbourne Ave.Dickson southbound near Morphett St	North Canberra		At local centre/within 400m of school
2	1		1		129	5	58	4554	Northbourne Ave. Lyneham northbound near Murdoch St	North Canberra		Within 400m of School
2	1		1		130	4	12	4555	Northbourne Ave. Dickson southbound adjacent Karuah St	North Canberra		Service tourist facility
2	1		1		132	9	7	4557	Northbourne Ave. Braddon southbound near Wakefield Ave	North Canberra		Walk to employment node
2	1		1		133	9	58	4558	Northbourne Ave. Turner northbound near Macarthur Ave	North Canberra		Walk to employment node
2	1		1		134	1	3	4559	Northbourne Ave.Braddon southbound near Ipima St	North Canberra		Walk to employment node/within 400m of school,
2	1		1		135	13	58	4560	Northbourne Ave. Turner northbound north of Condamine St	North Canberra		Walk to employment node/within 400m of school,

Phase	Ad	Non-Ad	Existing Shelter	Relocation	RDG Drg #	Block	Section	Bus Stop Number	Location	Region	Request Type	GHD Comments
2	1		1		137	1	57	4562	Northbourne Ave. Turner northbound south of Condamine St	North Canberra		New route focuses on Northborne
2		1	None			74	134	4696	N/S Wanganeen St E/O Unaipon Ave	Ngunnawal	Action request	Within 400m of school
2		1	None			17	117	4697	S/S Wanganeen St E/O Unaipon Ave	Ngunnawal	Action request	Within 400m of school
2		1	None			1	139	4702	W/S Unaipon Avenue N/O Pemulwuy St	Ngunnawal	Public request	Within 400m of school
2		1	None			12	146	4704	E/O Len Water St N/O Burrumurra Ave	Ngunnawal	Public request	Peak hour volume
2		1	None			782	n/a	4708	E/S Mirrabei Drive N/O Wanganeen Ave	Ngunnawal	Public request	Within 400m of school
2		1	None			45	116	4709	W/S Mirrabei Drive N/O Wanganeen Ave	Ngunnawal	Public request	Within 400m of school
2		1	None			9	96	4713	S/S Mirrabei Dr W/O Shoalhaven Ave	Amaroo	Public request	Peak hour volume
2	1		1			11	99	4727	S/S Gundaroo Dr W/O Gunghalin Dr	Palmerston	Adshel request	Peak hour volume
2		1	None			1	30	4730	W/S Anne Clark Avenue S/O Monaghan Pl	Nicholls	Public request	Peak hour volume
2		1	None			4	104	4784	W/S Kosciuszko Ave N/O Bimberi Cres	Palmerston	Public request	Within 200m of Aged care facility
2		1	None			6	130	4785	Kosciuszko Ave (near Bimberi Cres/Alm Close underpass)	Palmerston	Public request	Peak hour volume
2		1	None					5043	Archdall St, Dunlop	Belconnen	Public request	Peak hour Volume
2		1	None					5049	Murdoch st Lyneham	Inner north	Public request	Action endorsed
2		1	None			3	83	5085	E/S Gozzard St S/O Heazlett St	Gungahlin	Public request	At local centre
2	1		None					7004	Hibberson St, Gungahlin	Gungahlin	Public request	Peak hour Volume
2	5		None						Cohen St Extension	Belconnen	Government Request	ACT Government Commitment
2	1		None						West Row	North Canberra	Government Request	ACT Government Commitment

<b>Sub Total Reduced Rollout</b>	
Ad	22
Non Ad	21
Relocations Provided by Ad Sites	12 plus 2 relocations left over from the start of phase 2
Relocations Required for a bunker	12

Phase	Ad	Non-Ad	Existing Shelter	Relocation	RDG Drg #	Block	Section	Bus Stop Number	Location	Region	Request Type	GHD Comments
Remaining Shelters to be installed under Phase 2												
2		1	None		2	65	266	0002	Athllon Dr.northbound north of Learmonth Dr	Tuggeranong	Action request	To be postponed due to Athllon Dr Duplication (08/09)
2			None	1		24	65	1028	W/S Duggan St N/O Beckett St	Calwell	Public request	Peakhour volume, Shelter constructed 100m down the road
2	1		None			6	4	1059	N/S Soward Way E/O Scolloy St	Greenway	Action request	At local Centre
2		1	None			3	57	1067	E/S Anketell St N/O Sheerin St	Greenway	Action request	Walk to employment node/at local centre
2		1	None			8	56	1068	W/S Anketell St N/O Sheerin St	Greenway	Action request	Walk to employment node/at local centre
2			None	1		1	577	1191	W/S Knoke Ave S/O McGilvray Close	Gordon	Action request	Within 400m of school
2			None	1		55	13	1208	S/S Tom roberts ave W/O Beaumaris St	Banks	Public request	Within 400m of school , Requires further investigation into justification.
2		1	None			36	205	1386	N/S Longmore st, east of Langdon Ave	Wanniassa	Action request	At local centre
2		1	None			31	145	1429	W/S Sternberg, north of Ireland Pl	Wanniassa	Action request	Within 400m of school
2			None	1				1511	Castleton	Gowrie	Public request	Peak hour volume
2			None	1		9	567	1538	S/S Norriss W/O Woodburn St	Chisholm	Action request	Within 400m of school
2		1	None					1608	E/S McMillan Cres S/O Canberra Ave	Griffith	Adshel Proposed	Within 400m of school
2		1	None					1609	W/S McMillan Cres S/O Canberra Ave	Griffith	Adshel Proposed	Within 400m of school
2		1	None			25	91	2023	E/S Throssel St S/O Robertson St	Curtin	Public request	Walk to community facility, Difficult site to construct
2	1		None					2088	N/S Botany St E/O Melrose Dr	Woden	Adshel request	Industrial Area-Walk to employment node
2	1		None			1	111	2093	W/S Yamba Dr Outside Eddison Park	Woden	Adshel request	Within 400m of School
2			None	1				2163	Perry dr, Chapman	Weston	Public request	Within 400m of school
2			None	1				2189	McInnes	Weston	Adshel Proposed	Within 200m of Aged Care
2			None	1		1	95	2198	S/S Hilder Street E/O McCubbin St	Weston	Relocation list	Within 400m of school
2		1	None			10	48	2219	S/S Gawler Cres W/O Bedford St	Deakin	Action request	Within 400m of school
2	1		1					2223	W/S Hopetoun Circuit N/O Grose St	Deakin	Adshel request	At local centre
2	1		1		48	3	22	2254	National Cct., Barton, northbound near Sydney Ave.	Barton		Walk to employment node
2	1		1		49	1	27	2255	National Cct., Barton, southbound near Sydney Ave.	Barton		Walk to employment node
2	1		1			2	16	2257	National Cct., Barton, near Brisbane Ave.	Barton		Walk to employment node
2			None	1		23	16	2286	S/S Macgregor St E/O Chermiside St	Deakin	Adshel Proposed	At local centre
2			None	1		47	37	2289	E/S Yambina Cres S/O Nemarang Cres	Warramanga	Relocation list	Within 400m of school
2			None	1				2313	Melbourne Ave	Forrest	Adshel Proposed	Within 400m of school
2	1	1	1			3	96	2327	E/S Franklin St N/O Flinders St	Manuka	DOUBLE SHELTER	At Local Centre DA REQUIRED
2	1		None			47	8	2378	E/S Yamba Dr Opp Eddison Park	Woden	Adshel request	Within 400m of School
2			None	1		4	7	2384	W/S Nyrang st N/O Canberra Ave	Fyshwick		Walk to community facility
2	1		1			11	26	2388	S/S Newcastle St W/O Isa St	Fyshwick	Adshel request	Industrial Area-Walk to employment node

Phase	Ad	Non-Ad	Existing Shelter	Relocation	RDG Drg #	Block	Section	Bus Stop Number	Location	Region	Request Type	GHD Comments
2	1		1			2	16	2446	S/S Brisbane Ave, W/O National Cct	Barton		Walk to employment node
2				1				2471	Lambrigg St Farrer	Farrer	Public request	Within 400m of school , Requested 22/6/09 , High Priority
2			None	1				2549	Nyrang st	Narrabundah		Walk to community facility
2			None	1				2556	Melbourne Ave	Deakin	Adshel Proposed	Within 400m of school
2			None	1		1	87	2571	W/S Jerrabomberra Ave N/O Lumeah St	Narrabundah	Adshel Proposed	Within 400m of school
2	1		1		61	17	1	2602	Hindmarsh Dr., Phillip, eastbound west of Yamba Dr.	Woden		Within 400m of School
2	1		1		62	22	61	2603	Hindmarsh Dr., Phillip, westbound west of Yamba Dr.	Woden		Within 400m of School
2	1		1		64	1	49	2610	Athlon Dr., Pearce northbound north of Mawson Dr	Woden		At Local Centre
2	1		1		67	55	21	2652	Athlon Dr., Torrens northbound north of Beasley St	Woden		Within 400m of School
2		1	None			21	10	2686	Wormald St	Symonston	Public request	Walk to community facility (eye hospital), Difficult site to construct will need consultation with eye hospital
2		1						2691	Palmer St Garran	Garran	Public request	At Canberra Hospital
2	1		None			2	9	2919	W/S Ipswich St N/O Canberra Ave	Fyshwick	Adshel request	Industrial Area-Walk to employment node
2	1		None		86	3	6	3036	London Cct. Northbound north of Edinburgh	City		Walk to employment node (low patronage ACTION)
2	1		1		88			3042	Allinga St.westbound west of West Row	City		At Local Centre
2	1		1					3055	Ainslie Ave, Reid	City		Within 400m of School
2	1		1					3056	Ainslie Ave, Reid	City		Within 400m of School
2			None	1		6	20	3076	W/S Blamey Cr S/O Chauvel St	Campbell	Public request	At local centre/within 400m of school, Difficult site to construct
2				1				3147	Cowper St, Near Wakefield Ave	Dickson	Public request	At aged care, Requested 3/6/09, High Priority
2			None	1				3210	Officer Cres	Ainslie	Adshel Proposed	Within 400m of School
2			None	1		1	47	3234	S/S Gooreen St W/O Chapman St	Braddon	Relocation list	Within 400m of school
2			None	1		7	20	3247	S/S Knox St E/S Harvey St	Watson	Adshel Proposed	At local centre/within 400m of school
2	1		None			1	31	3262	N/S National Cct E/O Canberra Ave	Barton	Adshel request	Within 400m of School
2	1		1			11	30	3263	S/S National Cct E/O Canberra Ave	Barton	Adshel request	Within 400m of School
2			None	1		6	21	3391	N/S Knox St. Outside Ovals	Watson	Action request	Within 400m of school
2			None	1		15	31	3428	S/S Aspinall St. E/O Stirling Ave	Watson	Action request	Walk to community facility/at tourist site
2		1	None			14	13	3434	N/S Ginninderra Dr, E/O Lance Hill Ave	Dunlop	Relocation list	Peak hour volume, 7 passengers in peak hour
2			None	1		12	107	3443	W/S Lance Hill Ave N/O Santry Pl	Dunlop	Relocation list	Peak hour volume, 6 passengers in peak hour, site distance problems need to push the shelter back as per GHD design
2			None	1		1	144	4010	E/S Baldwin Dr N/O Ginninderra Dr	Kaleen	Adshel Proposed	Within 400m of school
2			None	1				4036	Maribymong Avenue	Kaleen	Adshel Proposed	At local centre
2		1	None			17	29	4037	N/S Maribyrnong W/O Georgina Cres	Kaleen	Relocation list	At local centre
2			None	1		21	166	4067	E/S John Cleland Cres N/O Twelvetreets Cres	Florey	Action request	Within 400m of school
2		1						4198	Companion Cres	Flynn	Public request	6 passengers in Peak hour requested 23/6/09
2	1		None					4271	Coulter drive, macquarie	Belconnen	Adshel request	Peak hour volume
2			None	1		1	92	4315	W/S Beaupaire Cres N/O Holt pl	Holt	Public request	At local centre
2	1		1		124	2	21	4530	Marcus Clarke St. northbound south of Barry Dr	City		At Local Centre
2	1		1		136	2	8	4561	Northbourne Ave. Braddon southbound south of Ipima St	North Canberra		New route focuses on Northborne
2	1		1		138	4	18	4563	Northbourne Ave. Braddon Southbound south of Girrahween St	North Canberra		Walk to employment node/high density development
2	1		1			2	41	4566	W/S Northbourne Ave S/O McKay St	Turner		Walk to employment/service high density area
	1		1					4567	Northbourne Ave, South of Morphet St	Dickson		Tourist information, uniformity
2		1	None			43	34	4583	N/S Antill St E/O Northbourne Ave	Dickson	Adshel Proposed	At local centre/walk to employment node
2	1		None			19	59	4604	Northbourne Ave. Lyneham northbound North of Mouat St	North Canberra		Walk to community facility
2		1	None			42	22	4640	S/S Templeton St W/O Henry St	Cook	Public request	Within 400m of school
2		1	None			19	27	4714	N/S Shoalhaven Ave E/O Mirabei Dr	Amaroo	Action request	Peak hour volume
2		1	None			1	43	4715	S/S Shoalhaven Ave E/O Mirabei Dr	Amaroo	Action request	Peak hour volume
2	1		None		tbc	32	51	4749	Northbourne Ave, intersection Phillip Avenue	North Canberra		At Tourist facility
2		1	None			12	154	4780	N/O Kosciuszko Ave outside Palmerston Primary School	Palmerston	Action request	Within 400m of school
2		1	None					4781	Kosciuszko Ave - adj to Primary School - (near Under Passes)	Palmerston		Within 400m of school
2		1	None			7	16	4792	E/S William Slim Dr S/O Chuculba Cres	Giralang	Action request	Peak hour volume



Phase	Ad	Non-Ad	Existing Shelter	Relocation	RDG Drg #	Block	Section	Bus Stop Number	Location	Region	Request Type	GHD Comments
2	1		None					4793	W/S William Slim Drive N/O William Webb Dr	Giralang		Peak hour volume
2	1		1			4	21	4803	W/S Haydon Drive N/O Belconnen Way	Bruce	Adshel request	At Hospital
2		1	None			3	85	4829	S/S Kosciuszko Ave E/O Tiptree Cres	Palmerston	Action request	Within 400m of school
2			None	1		1	60	4899	S/S Kerrigan St E/O Traeger St	Dunlop	Action request	Fast Developing area
2		1	None			24	101	5004	E/S Baldwin Dr S/O Maribyrnong Ave	Kaleen	Action request	Within 400m of school/walk to community facility
2			None	1		1	46	5026	S/S Kerrigan St opp Binney Cl	Dunlop	Action request	Fast Developing area
2	1		1			3	107	5054	S/S Gundaroo Dr W/O Nundurr Rd	Palmerston	Adshel request	Peak hour volume
2		1	None			7	60	5072	S/S Kelleway Ave E/O Lexcen Ave	Nicholls	Action request	Within 400m of schoo/at local centre
2		1	None					5086	Gozzard St	Gungahlin		At local centre
2			None	1		4	135	5102	S/S Kerrigan St opp Mary Hall Cct	Dunlop	Action request	Fast developing area
2		1	None			3	93	6000	N/S Burdekin St W/O Katherine Ave	Amaroo	Action request	Within 400m of school
2			None	1		7	131	6046	E/S Kerrigan St S/O Percy Begg Cct	Dunlop	Action request	Peak hour volume

Sub Total Remaining Phase 2	
Ad	33
Non-Ad	27
Relocations Required for a Bunker	
	32
Relocations Provided by Ad Sites	
	22

PHASE 2 TOTALS	
Ad	55
Non Ad	48
Relocations Provided by Ad Sites	34
Relocations Required for a bunker	44

PHASE 3 SHELTER LOCATIONS

Phase	Ad	Non-Ad	Existing Shelter	Relocati on	RDG Drg #	Block	Section	Bus Stop Number	Location	Region	Request Type	GHD Comments
3		1	1					1017	Webber cct, Calwell Centre	Calwell		At local centre
3	1		None					1061	N/S Soward Way E/O Anketell St	Tuggeranong	Adshel Requested	At local centre/within 400m of school
3		1	None					1080	Outtrim Ave Calwell	Tuggeranong	Public request	To be checked for justification
3		1	1					1147	Chisholm Centre, Benham St.	Group Shopping Centre		At local centre
3		1	1					1148	Benham st, Chisholm Centre	Chisholm		At local centre
3		1	1					1172	Comrie st, Erindale Centre	Erindale		At local centre
3		1	1					1173	Comrie st, Erindale Centre	Erindale		At local centre
3		1	None		16			1245	Tharwa Dr., Conder northbound north of Mentone	Tuggeranong	Action request	To be postponed due to Tharwa Dr Duplication (2008/09). This shelter has been knocked over
3				1				1278	O'Halloran Cct, Kambah	Tuggeranong		Within 400m of school
3				1				1279	O'Halloran Cct, Kambah	Tuggeranong		Within 400m of school
3		1	None					1317	Garratt st	Wanniassa	Public request	Within 200m of Aged care facility
3		1	None					1318	Garratt st	Wanniassa	Public request	Within 200m of Aged care facility
3	1		1		19			1341	Drakeford Dr., Kambah northbound north of Boddington	Tuggeranong		At local centre
3		1	1					1343	marconi cres	Kambah		At local centre
3		1	1					1344	marconi cres	Kambah		At local centre
3	1							1371	Drakeford Dr., Greenway northbound north of Taverner	Tuggeranong	Existing Council Request	Peak hour volume,
3	1		1					1375	Athllon Dr	Tuggeranong		At local centre
3	1		1		33			2002	Launceston St. westbound near Furzer St	Woden		Walk to employment node/walk to community facility
3	1		None		34			2031	Launceston St. eastbound near Furzer St	Woden		Walk to employment node/walk to community facility
3	1		1		37			2044	Southlands Shopping Centre, Heard St., Mawson	Group Shopping Centres		At local centre
3	1		None					2084	Melrose drive, Phillip	Woden		Walk to employment node
3		1	1					2195	N/S Hilder St S/O McInnes St	Weston	Adshel Proposed	Within 400m of school
3	1		1					2200	Namatjira Dr	Weston	Adshel Requested	Within 400m of Old Persons home - not on new action bus route???
2		1	1					2205	Cooleman Ct, Parkinson St., Weston eastbound	Weston		At local centre
3	1		1		46			2206	Cooleman Ct, Parkinson St., Weston westbound	Group Shopping Centres		At local centre
3	1		None					2233	Wentworth Ave	Kingston	Public request	Peak hour volume
3	1		None					2278	W/S Kent St S/O Strickland Cres	Deakin	Adshel Requested	Walk to Hospital/Within 400m of school
3		1	1					2285	N/S Macgregor St E/O De Chair St	Deakin	Adshel Proposed	Within 200m of Aged Care
3	1		None					2291	E/S Kent St S/O Strickland Cres	Deakin	Adshel Requested	Walk to Hospital/Within 400m of school
3	1		1		54			2304	Strickland Cres., Deakin eastbound Adjacent to John James Hospital	Deakin		Walk to community facility
3	1		1		55			2305	Strickland Cres., Deakin westbound adjacent to John James Hospital	Deakin		Walk to community facility
3	1		1					2382	Yamba Drive, Phillip	Woden		Walk to community facility
3	1		None					2387	E/S Ipswich St N/O Canberra Ave	Fyshwick	Adshel Requested	Industrial area-walk to employment node
3	1		None					2598	S/S Giles St at Kingston Shops	Kingston	Adshel Requested	At local centre
3	1		1					2609	E/S Athllon Dr S/O Beasley St	Woden		At local centre/within 400m of school
3	1		None					2622	E/S Wollongong St N/O Newcastle St	Fyshwick	Adshel Requested	Industrial area-walk to employment node
3	1		None					2690	Namatjira Dr	Weston	Adshel Requested	Within 400m of Old Persons home - not on new action bus route???
3	1		None					2941	N/S Newcastle St E/O Isa St	Fyshwick	Adshel Requested	Industrial area-walk to employment node
3	1		1					3025	N/S Carruthers St W/O Denison St	Curtin	Adshel Requested	Within 200m of Old persons home
3	1		1					3164	Cowper st, adjacent to swimming pool	Dickson		At local centre, busy stop
3	1		1					3380	Wattle St Outside Shops Lyneham	Lyneham	Adshel Requested	At local centre/within 400m of school
3	1		None					3398	Wattle St Outside Shops Lyneham	Lyneham	Adshel Requested	At local centre/within 400m of school

Phase	Ad	Non-Ad	Existing Shelter	Relocati on	RDG Drg #	Block	Section	Bus Stop Number	Location	Region	Request Type	GHD Comments
3	1		None		101			3441	College St. eastbound outside the swimming centre	Belconnen		Walk to community centre
3	1		None		102			3442	College St.westbound opposite the swimming centre	Belconnen		Walk to community centre
3	1		None					3450	London Cct, City	North Canberra	Stop Relocated (mario sallechchia)	At local centre
3		1	1					4065	John Cleland	Florey	Adshel Proposed	Within 400m of school
3	1		1					4295	Belconnen way, Scullin	Belconnen		Walk to Community Facility
3	1		1					4327	Southern Cross drive, Macgreggor	Belconnen		Within 400m of School
3		1						4322	Spofforth St, Holt	Belconnen	Public request	Peak hour Volume, only 5 at present
3	1		None					4358	Southern Cross Drive, Latham eastbound east of Ologhlen	Latham		within 400m of school
3	1		1					4360	Southern Cross Drive, Latham eastbound west of Ologhlen	Latham		within 400m of school
3	1		1					4397	Southern Cross Drive, Latham eastbound east of Dalley Cr	Latham		within 400m of school
3		1	None					4450	Beetaloo st Hawker	Belconnen	Public request	Peak hour volume
3	1		1					4493	W/S Bindubi St S/O Belconnen Way, Macquarie	Belconnen	Adshel Requested	Within 400m of school
3	1		1					4494	E/S Bindubi St S/O Belconnen Way, Macquarie	Belconnen	Adshel Requested	Within 400m of school
3	1		None					4515	Jamison Shopping Centre, Bowman St., Macquarie	Macquarie	Existing Council Request	At local centre
3	1		None					4516	Jamison Shopping Centre, Bowman St., Macquarie	Macquarie	Existing Council Request	At local centre
3	1		1					4517	Jamison Shopping Centre, Bowman St., Macquarie	Macquarie	Existing Council Request	At local centre
3	1		None			1	63	4527	ENS Barry Drive W/O Daley Rd	Acton	Adshel request	Within 400m of ANU
3	1		1					4528	W/S Barry Drive W/O Daley Rd	Acton	Adshel request	Within 400m of ANU
3	1		1					4531	N/S Alinga St W/O West Row	City		At local centre
3	1		1					4547	E/S Mouat St outside Hockey Centre	Lyneham	Adshel Requested	Within 200m of Old persons home
3	1		None					4575	N/S Macarthur Avenue Outside school O'Connor	North Canberra		Within 400m of school
3	1		1					4584	S/S Antill St Opp Pigot St	Dickson		At local centre
3		1	1					4699	Unaipon Avenue	Ngunnawal	Adshel Proposed	Within 400m of school
3		1	None					4751	Flemington Road Adjacent to Epic Centre	North Canberra	Action request	
3	1		1		153			4825	Belconnen Way, Hawker eastbound opposite Hawker Oval	Belconnen		within 400m of school
3	1		1		154			4826	Belconnen Way, Hawker eastbound near Petterd St	Belconnen		within 400m of school
3	1		1					5003	Southern Cross Dr E/O Ratcliffe Cres Florey	Belconnen	Adshel Requested	Within 400m of school
3		1	None					6067	Moonlight Cres Gungahlin	Gungahlin	Public request	To be checked for justification
3	1		None					3451A	Akuna st, City	North Canberra	New stop (mario sallechchia)	At local centre
3	1		None					3451B	Akuna st, City	North Canberra	New stop (mario sallechchia)	At local centre
3	1		None					Unknown	Flemington Road near Mapleton Ave	Mitchell	ACT Govt Request	New development and road do up
3	1		None					Unknown	Flemington Road near Nullarbor Ave	Mitchell	ACT Govt Request	New development and road do up
3	1		None					Unknown	Flemington Road near Wells Station Road	Mitchell	ACT Govt Request	New development and road do up
3		1	None					6066	Moonlight Cres Gungahlin	Gungahlin	GHD Suggest	Peak Hour Volume
2	1		1					2550	Mildura St, Fyshwick	South Canberra	Public request	Walk to Fyshwick Markets, DA required

<b>Totals</b>	
<b>Ad</b>	54
<b>Non-Ad</b>	21
<b>Relocations provided by Ad Shelters</b>	40
<b>Relocations required for a bunker</b>	2



Appendix C

# Bus Shelter Design

ADSHEL EVO Mk III

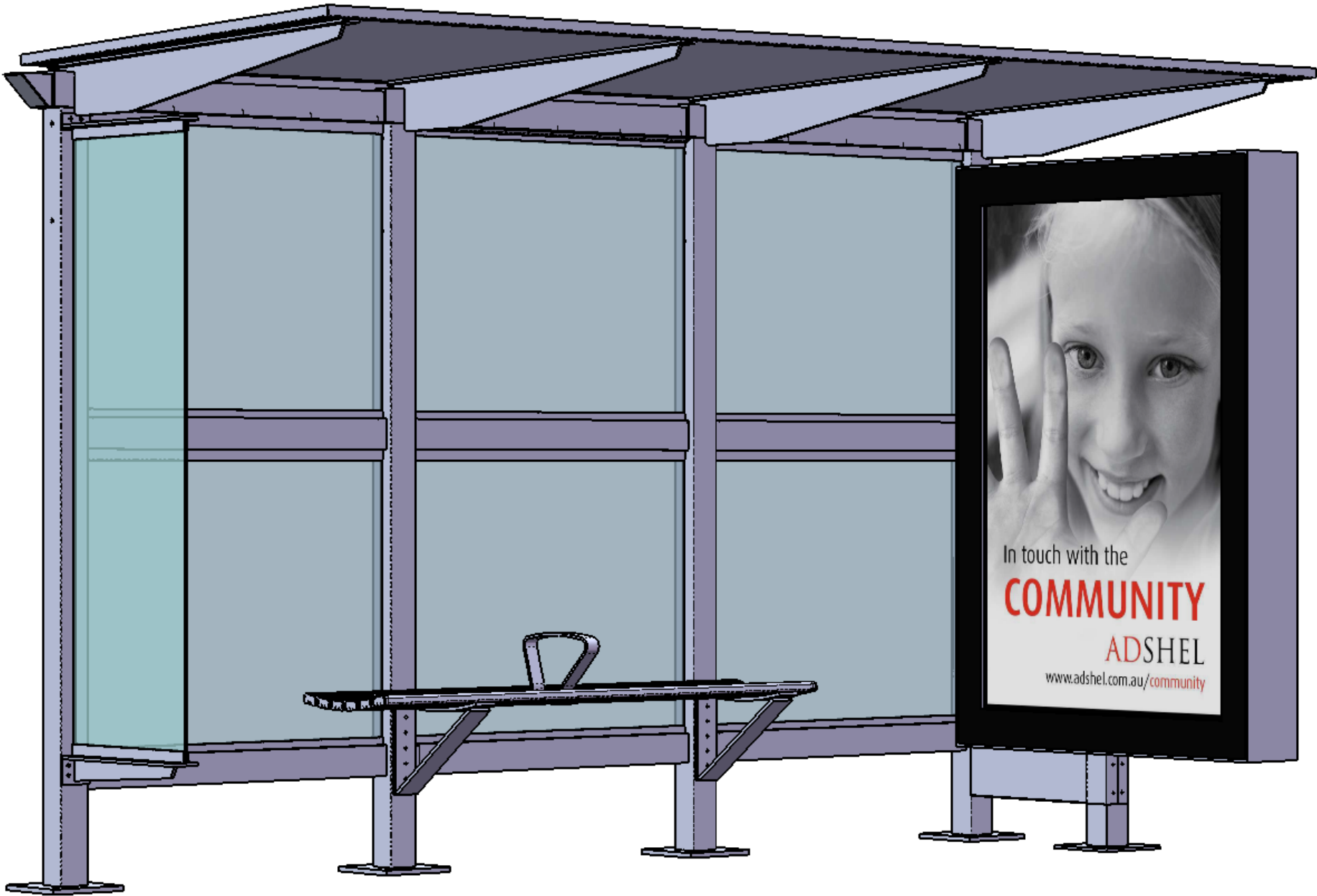

UNLESS OTHERWISE SPECIFIED: DIMENSIONS ARE IN MILLIMETERS = XX = INDICATES DIMENSION SYMMETRIC ABOUT CENTRELINE	TOLERANCES:  LINEAR: ± 0.5mm ANGULAR: ± 0.5°	DRAWN: GB	DATE: 9/07/2008	ADSHL level 11, 205 pacific hwy st leonards nsw 2065 t: +61 (0) 2 84257200 f: +61 (0) 2 84257222		TITLE: EVO MKIII EVO FB AD MAINS		DRAWING NO: 11560		REV: A.0  PART.DWG	
		CHECKED: -	DATE:								
		ENG:	DATE:								
CAD GENERATED DRAWING DO NOT MANUALLY UPDATE  DO NOT SCALE DRAWING						MATERIAL:	FINISH:	SIZE: A3	SCALE: 1:15	SHEET: 1 OF 5	

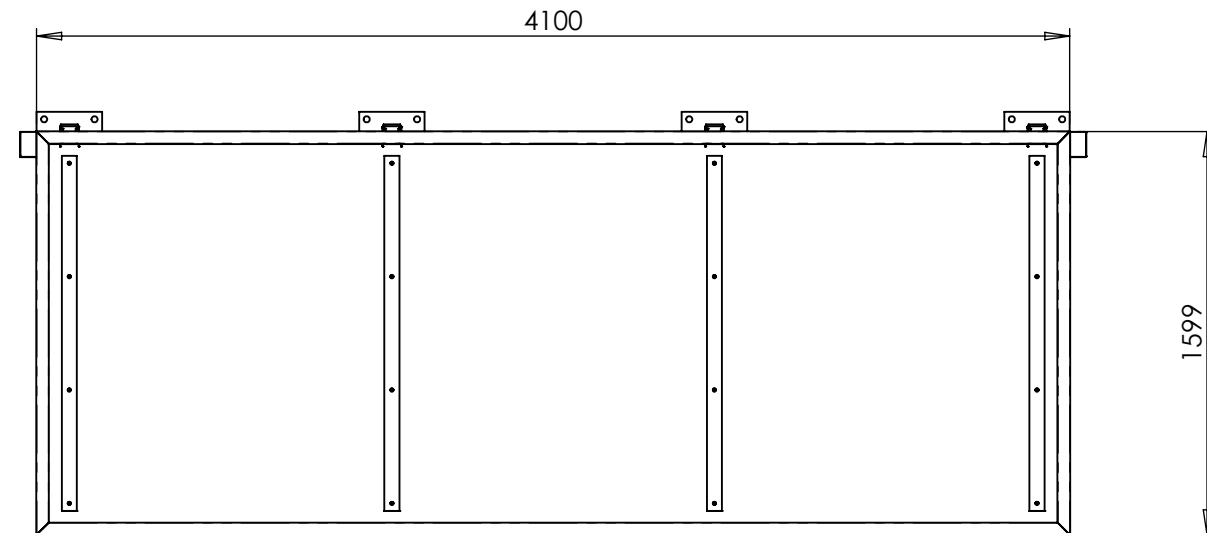

TOP VIEW

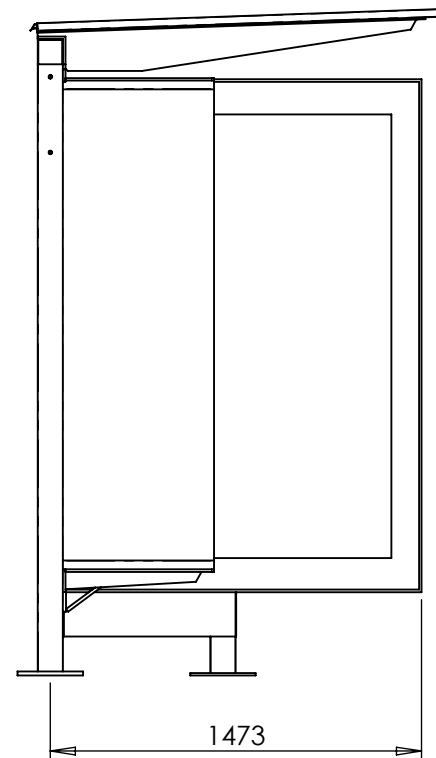

LEFT SIDE VIEW

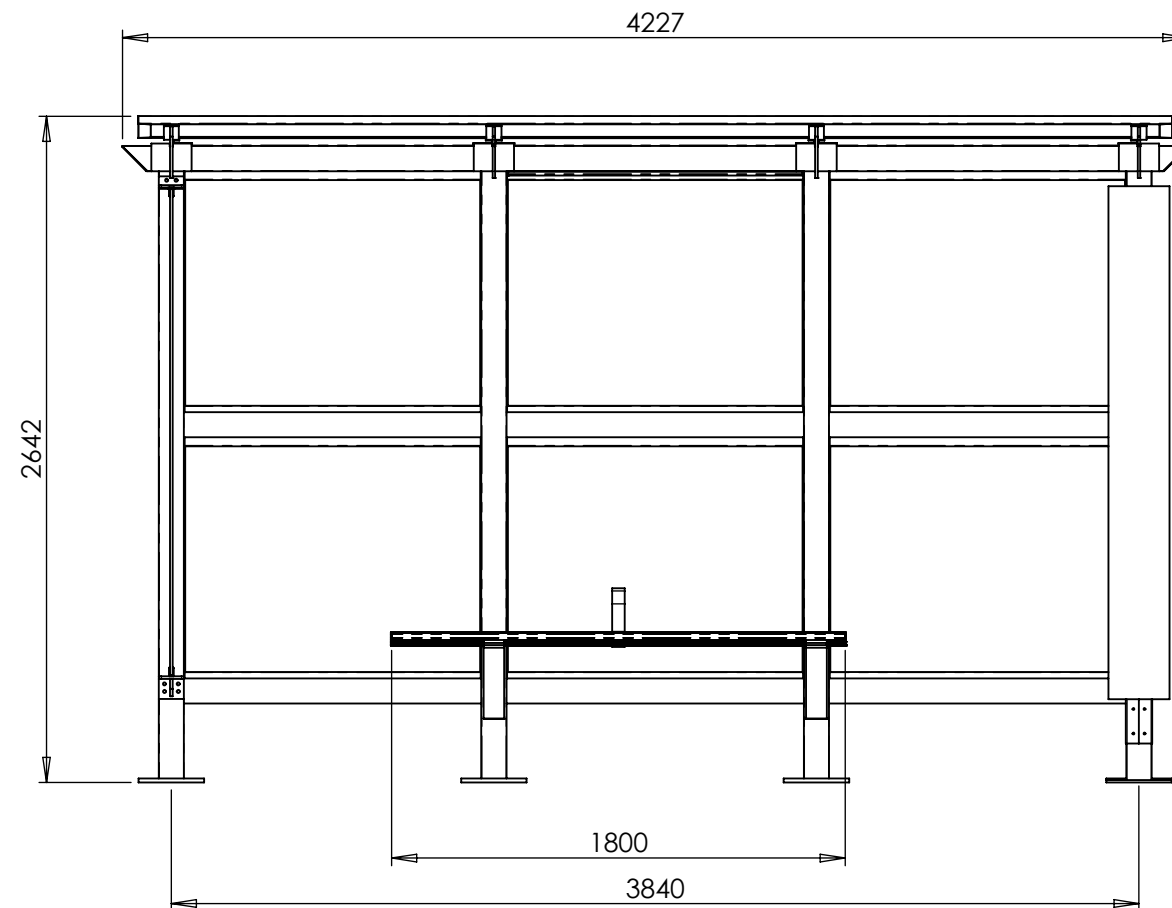

FRONT VIEW

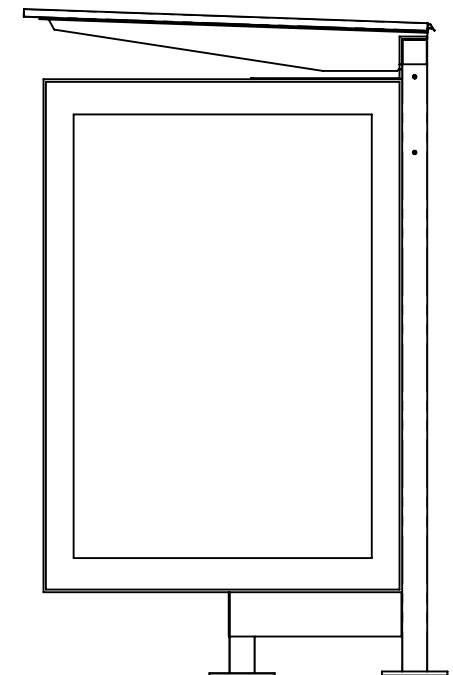

RIGHT SIDE VIEW

UNLESS OTHERWISE SPECIFIED: DIMENSIONS ARE IN MILLIMETERS = XX = INDICATES DIMENSION SYMMETRIC ABOUT CENTRELINE	TOLERANCES:  LINEAR: ± 0.5mm ANGULAR: ± 0.5°	DRAWN:  GB	DATE:  9/07/2008	<div>ADSH EL</div> <div>level 11, 205 pacific hwy st leonards nsw 2065 t: +61 (0) 2 84257200 f: +61 (0) 2 84257222</div>	TITLE: EVO MKIII EVO FB AD MAINS		DRAWING NO: 11560		REV: A.0
CAD GENERATED DRAWING DO NOT MANUALLY UPDATE  DO NOT SCALE DRAWING		CHECKED:  -	DATE:		MATERIAL:	FINISH:	SIZE: A3	SCALE: 1:30	PART.DWG
		ENG:	DATE:						SHEET: 2 OF 5

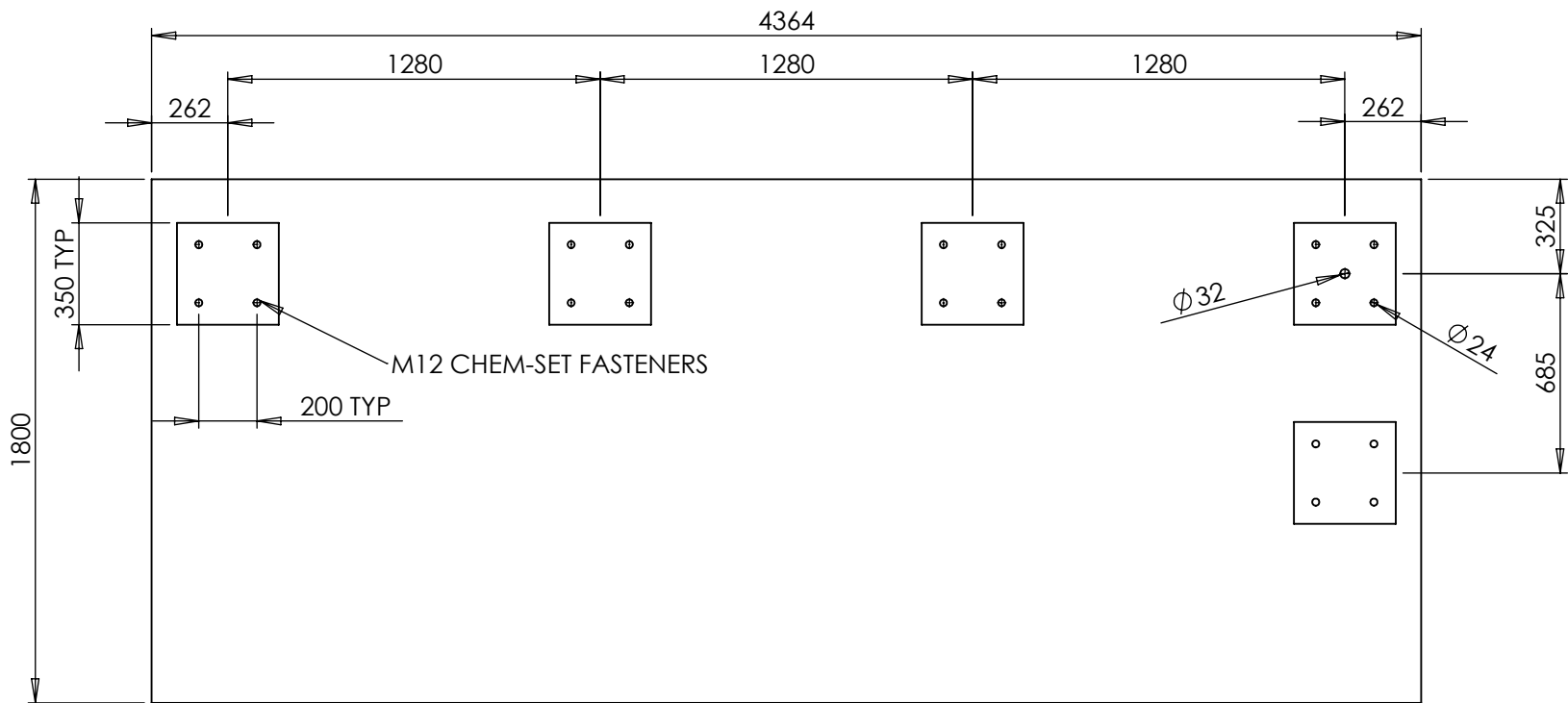

CONDUIT LOCATIONS ARE CRITICAL

CONCRETE REQUIREMENT :

- MPA25
- SLUMP 80mm
- MAXIMUM AGGREGATE = 20mm
- MINIMUM DENSITY = 2400kg/mm3

REINFORCEMENT :

- MINIMUM COVER OVER REINFORCEMENT = 60mm

FASTERNERS:

- 4xoff M12 CHEM-SET FASTERNERS PER
- UPRIGHT,MINIMUM OF 150mm EMBEDMENT

DIMENSIONS BASED ON UPON METRO MKII  
CERTIFIED FOOTING

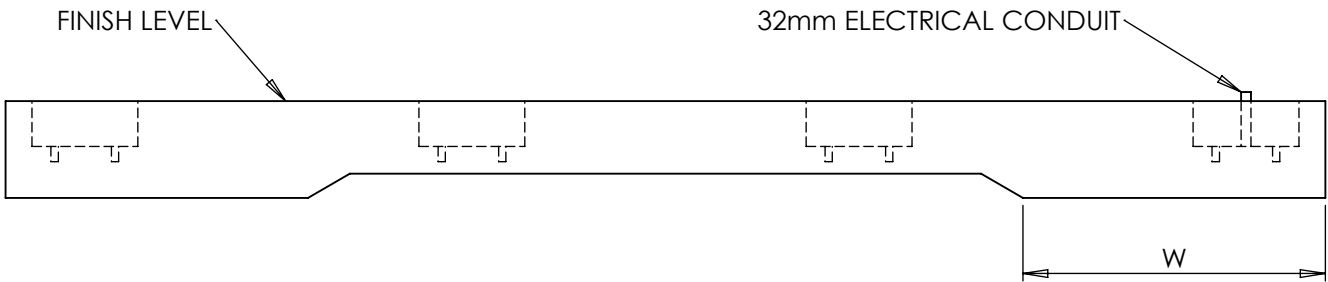

REGION	DESCRIPTION	ULTIMATE BASIC WIND SPEED(m/s)	W (mm)	D (mm)	REINFORCEMENT TOP AND BOTTOM
A	NORMAL	50	910	240	REF 92
B	INTERMMEDIATE	60	1250	240	REF 92

UNLESS OTHERWISE SPECIFIED:  
DIMENSIONS ARE IN MILLIMETERS  
= XX = INDICATES DIMENSION  
SYMMETRIC ABOUT CENTRELINE

CAD GENERATED DRAWING  
DO NOT MANUALLY UPDATE  
  
DO NOT SCALE DRAWING

TOLERANCES:  
  
LINEAR: ± 0.5mm  
ANGULAR: ± 0.5°

DRAWN: GB  
CHECKED: -  
ENG:

DATE: 9/07/2008  
DATE:  
DATE:

ADSHEL  
level 11, 205 pacific hwy  
st leonards nsw 2065  
t: +61 (0) 2 84257200 f: +61 (0) 2 84257222

TITLE:  
EVO MKIII  
FOOTINGS

MATERIAL:  
  
FINISH:

DRAWING NO:  
11560

REV:  
A.0  
  
PART.DWG

SIZE:  
A3

SCALE:  
1:25

SHEET:  
3 OF 5

Authorised by the ACT Parliamentary Counsel—also accessible at [www.legislation.act.gov.au](http://www.legislation.act.gov.au)

(11560-A.0 EVO FB AD MAINS)



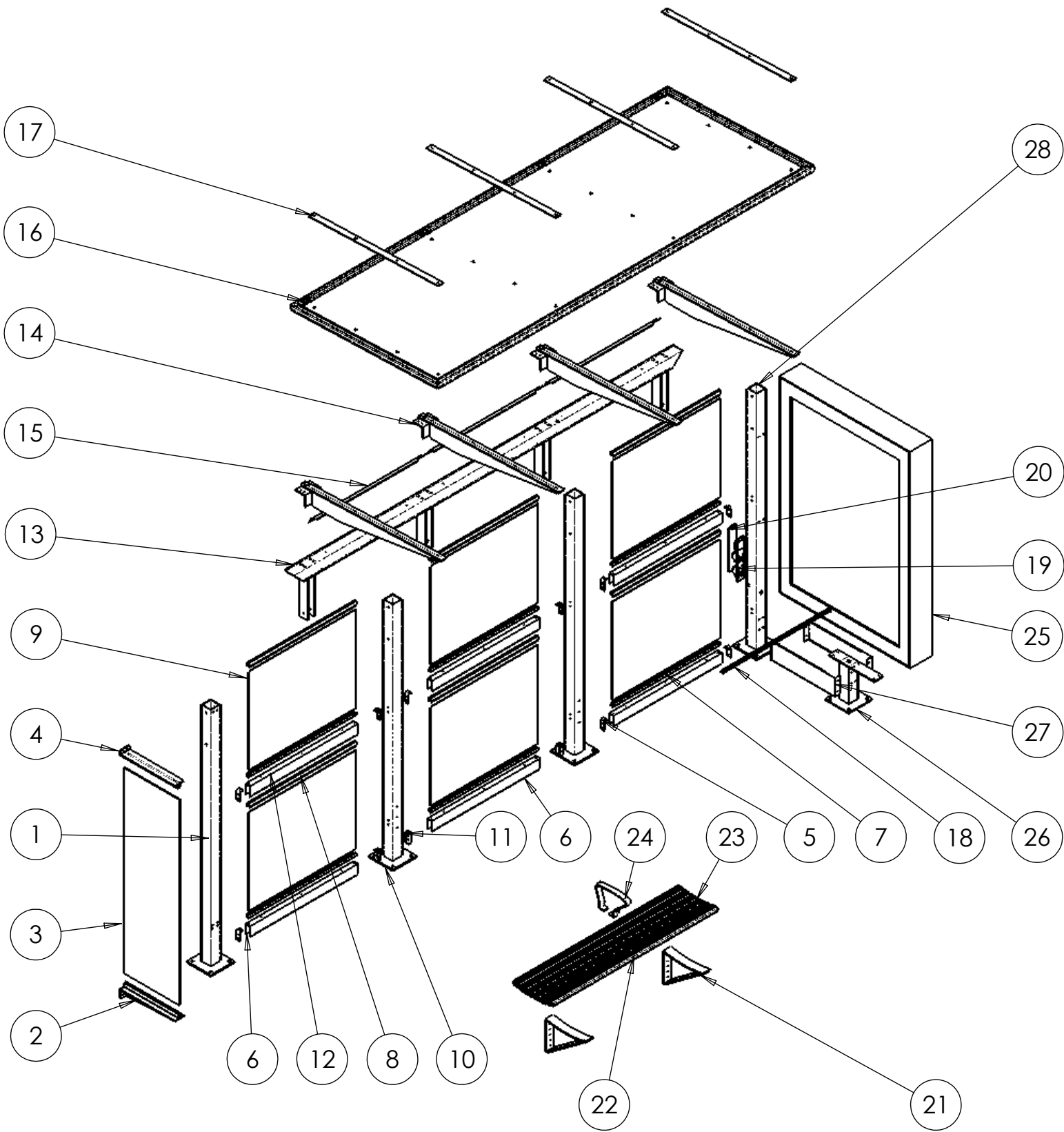

ITEM	QTY.	NUMBER	DESCRIPTION	MATERIAL	SIZE
1	1	11561	UPRIGHT 1 ASSY	ALUMINIUM 6061 -T6	
	1	11561-1	BASEPLATE	ALUMINIUM 6061 -T6	16mm
	1	11560	UPRIGHT 1	ALUMINIUM 6061 - T6	
2	1	11583	LOWER WINDBREAK SUPPORT - 600	ALUMINIUM 6061 -T6	
	1	11580-1	UPPER SUPPORT - 600	ALUMINIUM 6061 -T6	10mm
	1	11583-2	LOWER PLATE - 600	ALUMINIUM 6061 -T6	10mm
	1	11583-3	LOWER SUPPORT WEB - 600	ALUMINIUM 6061 -T6	10mm
	1	50022	U GLASS HOLDER 5 - 600	ALUMINIUM 6063 -T6	
3	1	11578	WINDBREAK GLASS	TOUGHENED SAFETY GLASS	10mm
4	1	11580	UPPER WINDBREAK SUPPORT - 600	ALUMINIUM 6061 -T6	
	1	11580-1	UPPER SUPPORT - 600	ALUMINIUM 6061 -T6	10mm
	1	11580-2	UPPER PLATE	ALUMINIUM 6061 -T6	
	1	50022	U GLASS HOLDER 5 - 600	ALUMINIUM 6063 -T6	
5	10	11571	MID&BOTTOM RAIL BRACKET	ALUMINIUM 6063 -T6	
6	3	11579	BOTTOM RAIL	ALUMINIUM 6061 -T6	
7	6	11582-2	U GLASS HOLDER 3	ALUMINIUM 6063 -T6	
8	6	11584-2	U GLASS HOLDER 2	ALUMINIUM 6063 -T6	
9	6	11577	BACK GLASS	TOUGHENED SAFETY GLASS	6mm
10	2	11562	UPRIGHT 2 ASSY	ALUMINIUM 6061 -T6	
	1	11561-1	BASEPLATE	ALUMINIUM 6061 -T6	16mm
	1	11562	UPRIGHT 2	ALUMINIUM 6061 -T6	
11	2	11965	RAIL BKT CABLE ACCESS	ALUMINIUM 6063 -T6	3mm
12	3	11570	MID RAIL	ALUMINIUM 6061 -T6	100X50
13	1	11817	TOP BEAM ASSM		
	1	11818	TOP BEAM 2	ALUMINIUM	
	4	11568	SPIGOT	ALUMINIUM 6061 -T6	
	2	11569	TOP BEAM END PLATE	ALUMINIUM	
14	4	11593	RAFTER ASSY		
	1	11567-1	RAFTER SUPPORT ANGLE	ALUMINIUM 6061 -T6	
	1	11567	RAFTER	ALUMINIUM 6061 -T6	
15	3	11961	RAIN COVER	ALUMINIUM	1.2mm
16	1	11587	ROOF ASSY (NON SOLAR)	ASSY	
	1	11576	ACM ROOF	ACM	
	2	11578-2	SIDE ROOF TRIM	ALUMINIUM 6063 -T6	
	1	11578-1	FRONT ROOF TRIM	ALUMINIUM 6063 -T6	
	1	11578-3	BACK ROOF TRIM	ALUMINIUM 6063 -T6	
	4	50265	GUTTER SPOUT	ALUMINIUM 6063 -T6	1mm
17	4	11567-1	RAFTER CAP	ALUMINIUM 6061 -T6	
18	1	11968	LED STRIP ASSY		
	1	11804	LED STRIP BOTTOM COVER	ALUMINIUM 6063 -T6	
	1	11596	LED STRIP TOP COVER	ALUMINIUM SHEET	0.9mm
	1	11598	LED STRIP END CAP - RIGHT	PP WITH UV PLASTIC	
	1	11597	LED STRIP END CAP - LEFT	PP WITH UV PLASTIC	
19	1	12218	ELECTRICAL COMP ASSY		
	1	12297	ELECTRICAL PLATE	ALUMINIUM	1.2mm
	2	50024	DIN RAIL	-	
	2	-	RCD/MCD (OPTIONAL)	-	
	1	-	TRANSFORMER	-	
20	1		COVER PLATE ASSY		
	1	50456	COVER PLATE 2	ALUMINIUM 6061 -T6	5mm
	1	50458	COVER PLATE RETAINER 2	ALUMINIUM	26X15
21	2	11573	SEAT SUPPORT BRACKET	ALUMINIUM 6061 - T5	
	1	11573-1	UPRIGHT SEAT SUPPORT	ALUMINIUM 6061 -T6	
	1	11573-3	TOP SEAT SUPPORT	ALUMINIUM 6061 -T6	
	1	11573-2	ANGLE SEAT SUPPORT	ALUMINIUM 6061 -T6	
22	6	11575	SEAT SLAT	ALUMINIUM 6061 -T6	
23	12	50004	SEAT END CAP	PP WITH UV PLASTIC	
24	1	11574	ARM REST	ALUMINIUM 6063-F CONDITION	
25	1		LIGHT BOX		
26	1	12286	UPRIGHT E ASSY	ALUMINIUM	
	1	12277	BASE PLATE	ALUMINIUM 6061 -T6	10mm
	1	50005	UPRIGHT E1	ALUMINIUM	
	1	50006	TOP PLATE	ALUMINIUM	
27	2	50030	BASE CLADDING	ALUMINIUM	2mm
28	1	11564	UPRIGHT 4 ASSY	ALUMINIUM 6061 -T6	
	1	11561-1	BASEPLATE	ALUMINIUM 6061 -T6	16mm
	1	11564	UPRIGHT 4	ALUMINIUM 6061 -T6	
	1	50465	COVER PLATE STOPPER 3	ALUMINIUM	26X15

UNLESS OTHERWISE SPECIFIED:  
DIMENSIONS ARE IN MILLIMETERS  
= XX = INDICATES DIMENSION  
SYMMETRIC ABOUT CENTRELINE

CAD GENERATED DRAWING  
DO NOT MANUALLY UPDATE  
  
DO NOT SCALE DRAWING

TOLERANCES:  
  
LINEAR: ± 0.5mm  
ANGULAR: ± 0.5°

DRAWN: GB  
CHECKED: -  
ENG:

DATE: 9/07/2008  
DATE:  
DATE:

ADSHHEL

level 11, 205 pacific hwy  
st leonards nsw 2065  
t: +61 (0) 2 84257200 f: +61 (0) 2 84257222

TITLE:  
EVO MKIII  
EVO FB AD MAINS

MATERIAL:

FINISH:

DRAWING NO:  
11560

REV:  
A.0

PART.DWG

SIZE:  
A3

SCALE:  
1:40

SHEET:  
4 OF 5

Authorised by the ACT Parliamentary Counsel—also accessible at [www.legislation.act.gov.au](http://www.legislation.act.gov.au)

(11560-A.0 EVO FB AD MAINS)



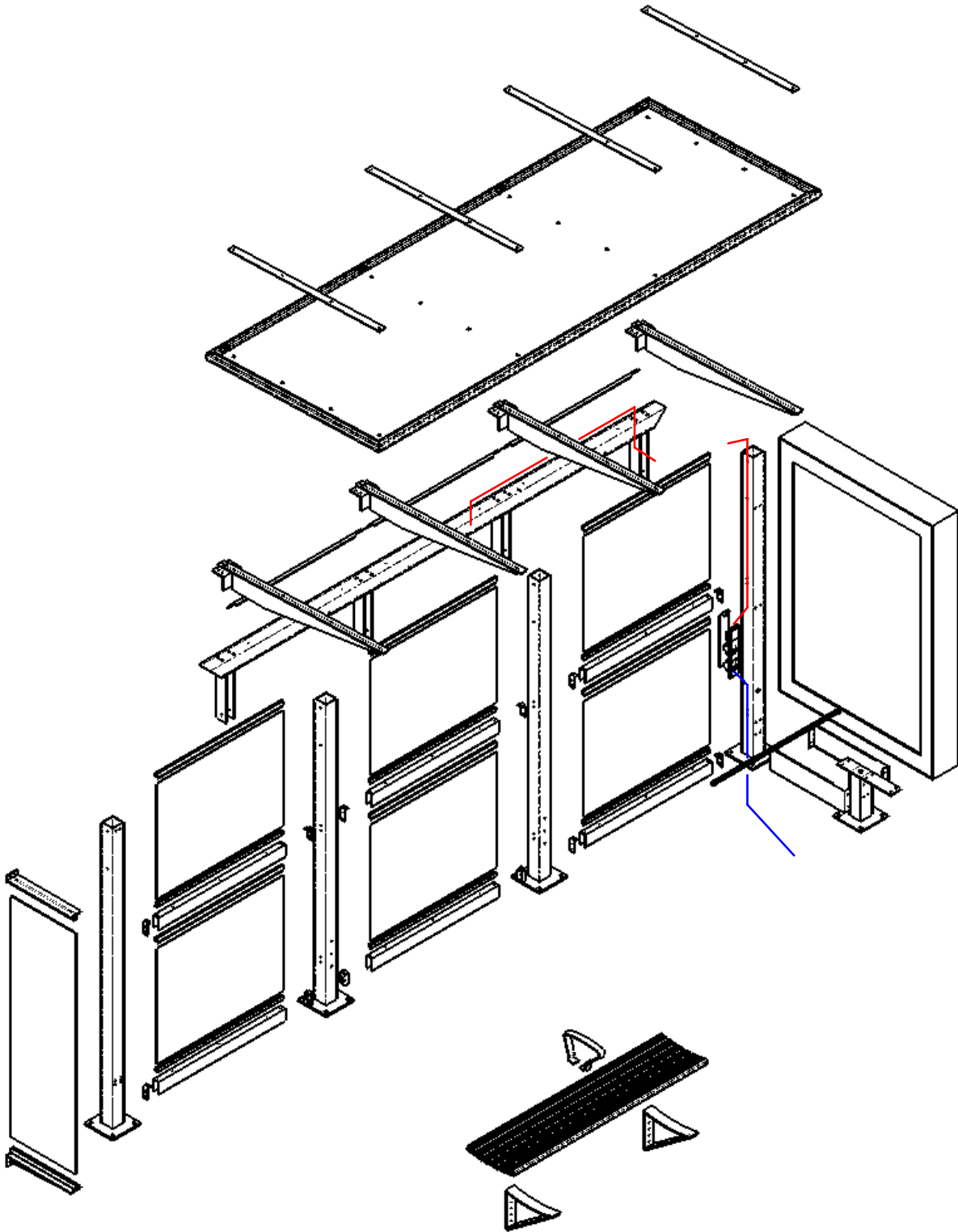

KEY:  
- SUPPLY (240V)  
- LOAD / LIGHTS (12V)

UNLESS OTHERWISE SPECIFIED: DIMENSIONS ARE IN MILLIMETERS = XX = INDICATES DIMENSION SYMMETRIC ABOUT CENTRELINE	TOLERANCES:  LINEAR: ± 0.5mm ANGULAR: ± 0.5°	DRAWN: GB	DATE: 9/07/2008	ADSHEL  level 11, 205 pacific hwy st leonards nsw 2065 t: +61 (0) 2 84257200 f: +61 (0) 2 84257222	TITLE: EVO MKIII EVO FB AD MAINS		DRAWING NO: 11560		REV: A.0	
		CHECKED: -	DATE:							
CAD GENERATED DRAWING DO NOT MANUALLY UPDATE  DO NOT SCALE DRAWING		ENG:	DATE:	MATERIAL:		FINISH:	SIZE: A3	SCALE: 1:40	PART.DWG	SHEET: 5 OF 5

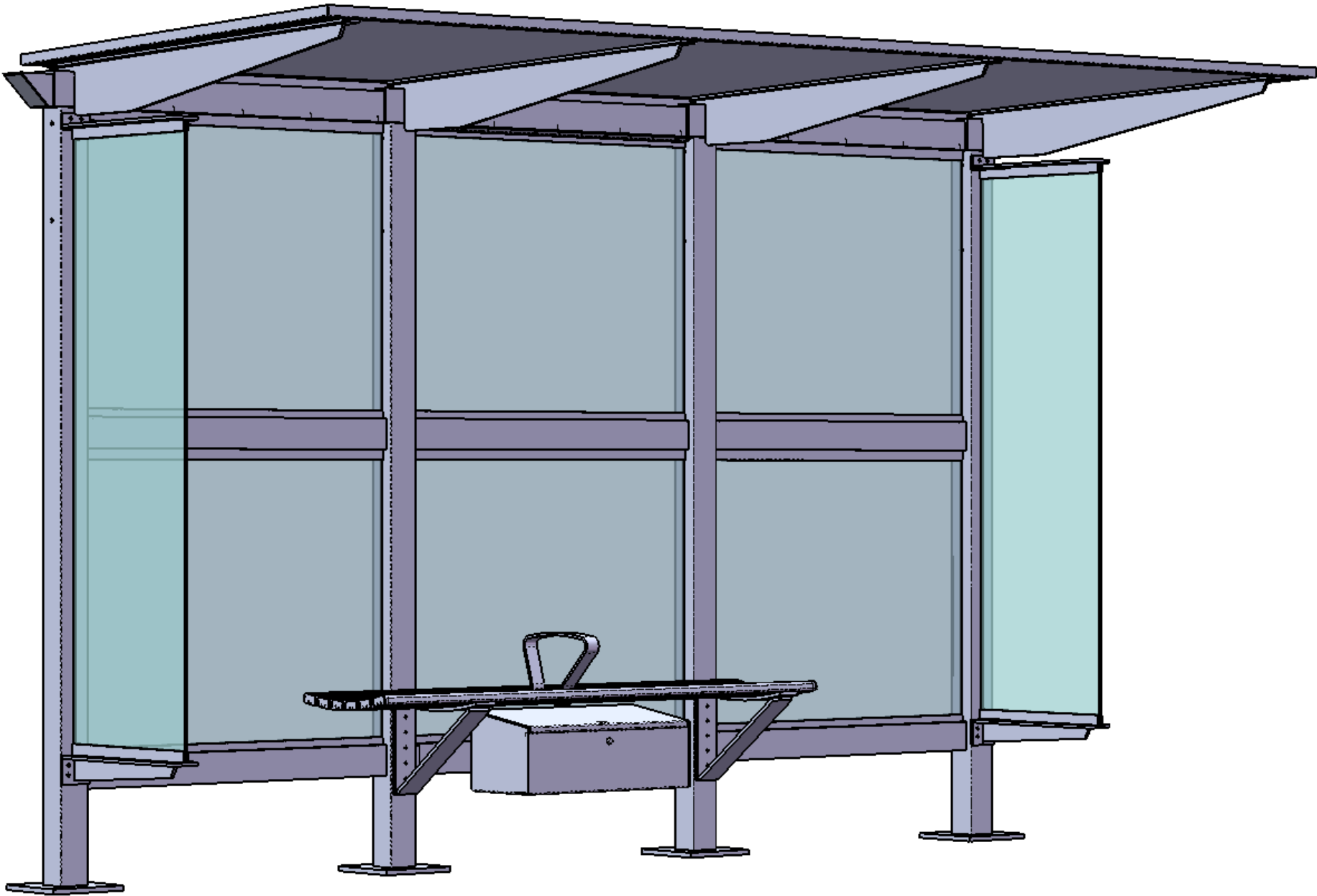

UNLESS OTHERWISE SPECIFIED: DIMENSIONS ARE IN MILLIMETERS = XX = INDICATES DIMENSION SYMMETRIC ABOUT CENTRELINE	TOLERANCES:  LINEAR: ± 0.5mm ANGULAR: ± 0.5°	DRAWN: GB	DATE: 9/07/2008	ADSH EL  level 11, 205 pacific hwy st leonards nsw 2065 t: +61 (0) 2 84257200 f: +61 (0) 2 84257222	TITLE: EVO MKIII EVO FB NON-AD SOLAR		DRAWING NO: 11594		REV: A.0	
		CHECKED: -	DATE:							
		ENG:	DATE:							
CAD GENERATED DRAWING DO NOT MANUALLY UPDATE  DO NOT SCALE DRAWING					MATERIAL:	FINISH:	SIZE: A3	SCALE: 1:15	PART.DWG  SHEET: 1 OF 5	

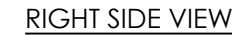

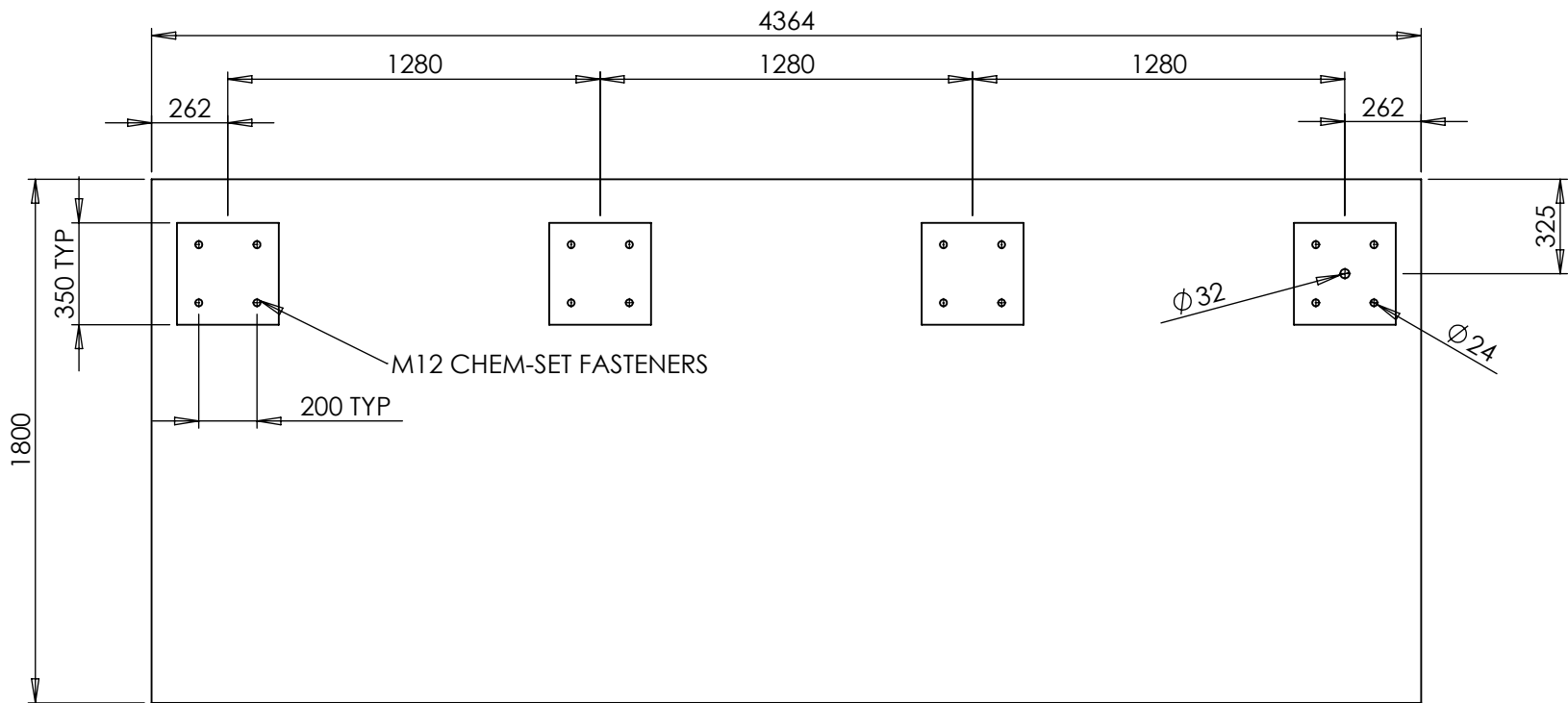

CONDUIT LOCATIONS ARE CRITICAL

CONCRETE REQUIREMENT :

- MPA25
- SLUMP 80mm
- MAXIMUM AGGREGATE = 20mm
- MINIMUM DENSITY = 2400kg/mm3

REINFORCEMENT :

- MINIMUM COVER OVER REINFORCEMENT = 60mm

FASTERNERS:

- 4xoff M12 CHEM-SET FASTERNERS PER
- UPRIGHT,MINIMUM OF 150mm EMBEDMENT

DIMENSIONS BASED ON UPON METRO MKII  
CERTIFIED FOOTING

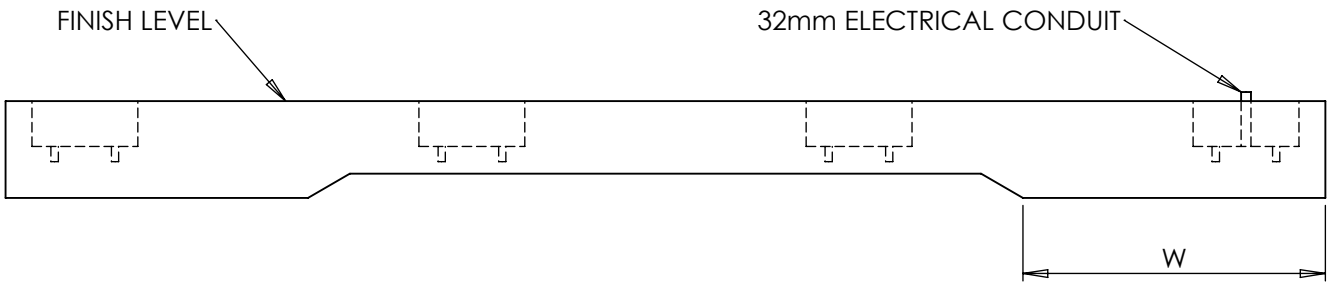

REGION	DESCRIPTION	ULTIMATE BASIC WIND SPEED(m/s)	W (mm)	D (mm)	REINFORCEMENT TOP AND BOTTOM
A	NORMAL	50	910	240	REF 92
B	INTERMMEDIATE	60	1250	240	REF 92

UNLESS OTHERWISE SPECIFIED:  
DIMENSIONS ARE IN MILLIMETERS  
= XX = INDICATES DIMENSION  
SYMMETRIC ABOUT CENTRELINE

CAD GENERATED DRAWING  
DO NOT MANUALLY UPDATE  
  
DO NOT SCALE DRAWING

TOLERANCES:  
  
LINEAR: ± 0.5mm  
ANGULAR: ± 0.5°

DRAWN: GB  
CHECKED: -  
ENG:

DATE: 9/07/2008  
DATE:  
DATE:

ADSHEL  
level 11, 205 pacific hwy  
st leonards nsw 2065  
t: +61 (0) 2 84257200 f: +61 (0) 2 84257222

TITLE:  
EVO MKIII  
FOOTINGS

MATERIAL:  
  
FINISH:

DRAWING NO:  
11594

REV:  
A.0  
  
PART.DWG

SIZE:  
A3

SCALE:  
1:25

SHEET:  
3 OF 5

Authorised by the ACT Parliamentary Counsel—also accessible at [www.legislation.act.gov.au](http://www.legislation.act.gov.au)

(11594-A.0 EVO FB NON-AD SOLAR)

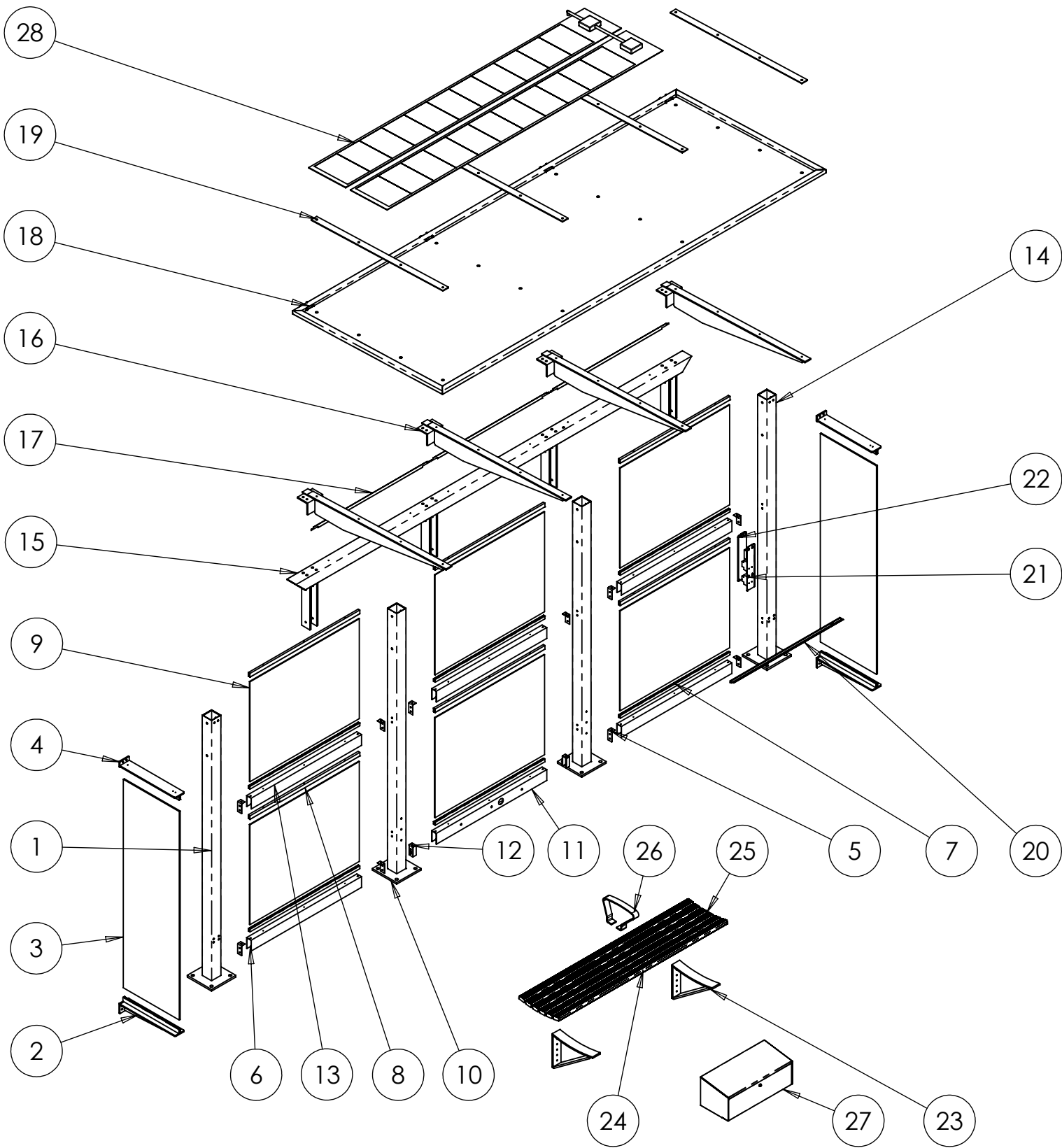

ITEM	QTY.	NUMBER	DESCRIPTION	MATERIAL	SIZE
1	1	11561	UPRIGHT 1 ASSY	ALUMINIUM 6061 -T6	
	1	11561-1	BASEPLATE	ALUMINIUM 6061 -T6	16mm
	1	11560	UPRIGHT 1	ALUMINIUM 6061 - T6	
2	2	11583	LOWER WINDBREAK SUPPORT - 600	ALUMINIUM 6061 -T6	
	1	11580-1	UPPER SUPPORT - 600	ALUMINIUM 6061 -T6	10mm
	1	11583-2	LOWER PLATE - 600	ALUMINIUM 6061 -T6	10mm
	1	11583-3	LOWER SUPPORT WEB - 600	ALUMINIUM 6061 -T6	10mm
	1	50022	U GLASS HOLDER 5 - 600	ALUMINIUM 6063 -T6	
3	2	11578	WINDBREAK GLASS	TOUGHENED SAFETY GLASS	10mm
4	2	11580	UPPER WINDBREAK SUPPORT - 600	ALUMINIUM 6061 -T6	
	1	11580-1	UPPER SUPPORT - 600	ALUMINIUM 6061 -T6	10mm
	1	11580-2	UPPER PLATE	ALUMINIUM 6061 -T6	
	1	50022	U GLASS HOLDER 5 - 600	ALUMINIUM 6063 -T6	
5	10	11571	MID&BOTTOM RAIL BRACKET	ALUMINIUM 6063 -T6	
6	2	11579	BOTTOM RAIL	ALUMINIUM 6061 -T6	
7	6	11582-2	U GLASS HOLDER 3	ALUMINIUM 6063 -T6	
8	6	11584-2	U GLASS HOLDER 2	ALUMINIUM 6063 -T6	
9	6	11577	BACK GLASS	TOUGHENED SAFETY GLASS	6mm
10	2	11562	UPRIGHT 2 ASSY	ALUMINIUM 6061 -T6	
	1	11561-1	BASEPLATE	ALUMINIUM 6061 -T6	16mm
	1	11562	UPRIGHT 2	ALUMINIUM 6061 -T6	
11	1	11815	BOTTOM RAIL 2	ALUMINIUM 6061 -T6	
12	2	11965	RAIL BKT CABLE ACCESS	ALUMINIUM 6063 -T6	3mm
13	3	11570	MID RAIL	ALUMINIUM 6061 -T6	100X50
14	1	11563	UPRIGHT 5 ASSY	ALUMINIUM 6061 -T6	
	1	11561-1	BASEPLATE	ALUMINIUM 6061 -T6	16mm
	1	11563	UPRIGHT 5	ALUMINIUM 6061 -T6	
	1	50457	COVER PLATE STOPPER 2	ALUMINIUM	26X15
15	1	11817	TOP BEAM ASSM		
	1	11818	TOP BEAM 2	ALUMINIUM	
	4	11568	SPIGOT	ALUMINIUM 6061 -T6	
	2	11569	TOP BEAM END PLATE	ALUMINIUM	
16	4	11593	RAFTER ASSY		
	1	11567-1	RAFTER SUPPORT ANGLE	ALUMINIUM 6061 -T6	
	1	11567	RAFTER	ALUMINIUM 6061 -T6	
17	3	11961	RAIN COVER	ALUMINIUM	1.2mm
18	1	11587	ROOF ASSY (NON SOLAR)	ASSY	
	1	11576	ACM ROOF	ACM	
	2	11578-2	SIDE ROOF TRIM	ALUMINIUM 6063 -T6	
	1	11578-1	FRONT ROOF TRIM	ALUMINIUM 6063 -T6	
	1	11578-3	BACK ROOF TRIM	ALUMINIUM 6063 -T6	
	4	50265	GUTTER SPOUT	ALUMINIUM 6063 -T6	1mm
19	4	11567-1	RAFTER CAP	ALUMINIUM 6061 -T6	
20	1	11968	LED STRIP ASSY		
	1	11804	LED STRIP BOTTOM COVER	ALUMINIUM 6063 -T6	
	1	11596	LED STRIP TOP COVER	ALUMINIUM SHEET	0.9mm
	1	11598	LED STRIP END CAP - RIGHT	PP WITH UV PLASTIC	
	1	11597	LED STRIP END CAP - LEFT	PP WITH UV PLASTIC	
21	1	12218	ELECTRICAL COMP ASSY		
	1	12297	ELECTRICAL PLATE	ALUMINIUM	1.2mm
	2	50024	DIN RAIL	-	
	2	-	RCD/MCD (OPTIONAL)	-	
	1	-	TRANSFORMER	-	
22	1		COVER PLATE ASSY		
	1	50456	COVER PLATE 2	ALUMINIUM 6061 -T6	5mm
	1	50458	COVER PLATE RETAINER 2	ALUMINIUM	26X15
23	2	11573	SEAT SUPPORT BRACKET	ALUMINIUM 6061 - T5	
	1	11573-1	UPRIGHT SEAT SUPPORT	ALUMINIUM 6061 -T6	
	1	11573-3	TOP SEAT SUPPORT	ALUMINIUM 6061 -T6	
	1	11573-2	ANGLE SEAT SUPPORT	ALUMINIUM 6061 -T6	
24	6	11575	SEAT SLAT	ALUMINIUM 6061 -T6	
25	12	50004	SEAT END CAP	PP WITH UV PLASTIC	
26	1	11574	ARM REST	ALUMINIUM 6063-F CONDITION	
27	1	11599	BATTERY COMPARTMENT ENCLOSURE ASSY		
	1		BATTERY BOX HINGE		
	1		BATTERY BOX HINGE		
	1	11800	BATTERY BOX	ALUMINIUM	3mm
	1	11801	BATTERY BOX DOOR	ALUMINIUM	3mm
	1		CAM LOCK		
	4	11803	RUNNER	ALUMINIUM	1mm
28	1		SOLAR PANEL ASSY		
	2		PVL PANEL		
	2		JUNCTION BOX		
	1		CORRUGATED CONDUIT		
	1		CORRUGATED CONDUIT 2		
	1		ELBOW GLAND		

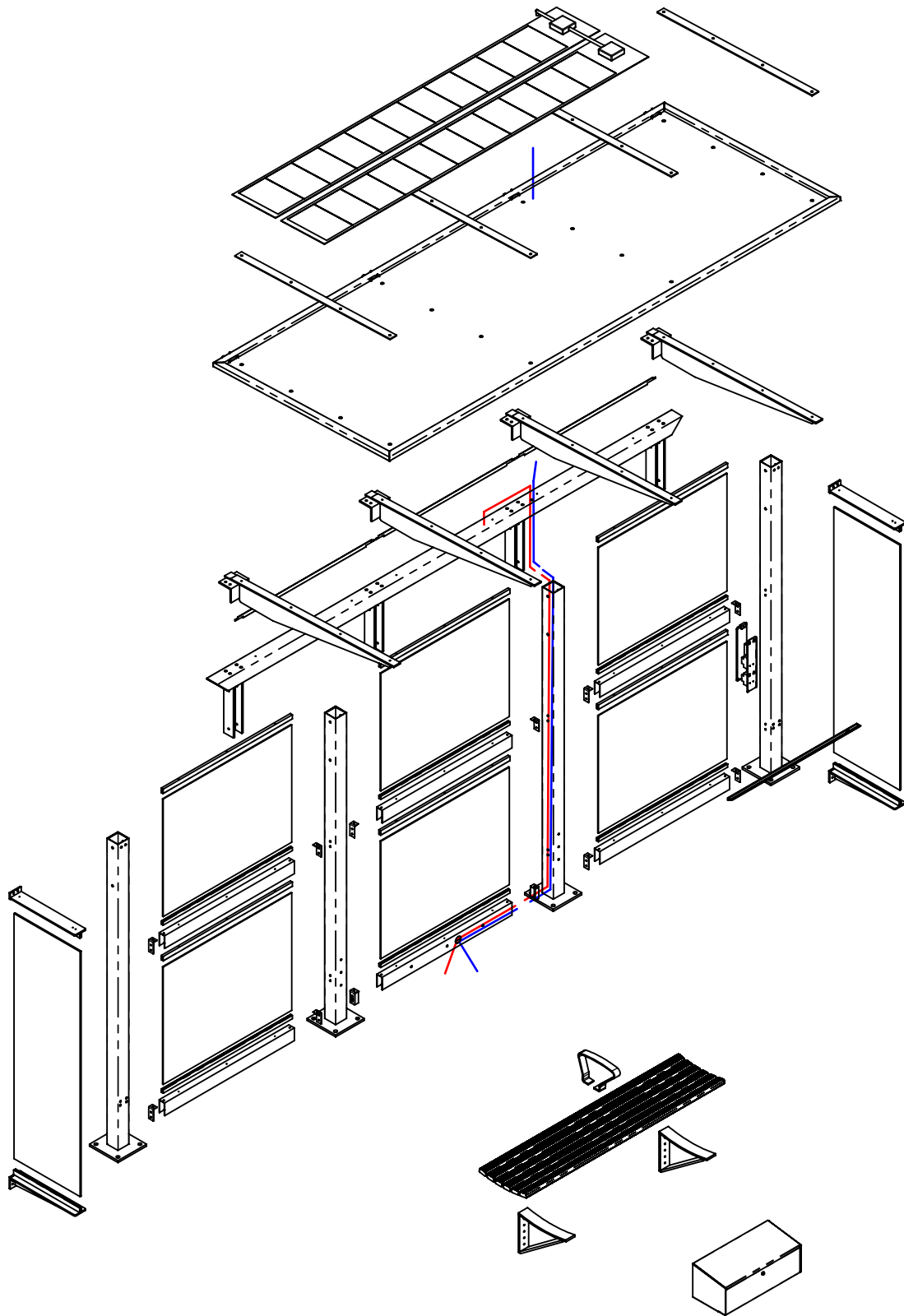

KEY:  
- SUPPLY (240V)  
- LOAD / LIGHTS (12V)

UNLESS OTHERWISE SPECIFIED: DIMENSIONS ARE IN MILLIMETERS = XX = INDICATES DIMENSION SYMMETRIC ABOUT CENTRELINE	TOLERANCES:  LINEAR: $\pm 0.5\text{mm}$ ANGULAR: $\pm 0.5^\circ$	DRAWN: GB	DATE: 9/07/2008	TITLE: EVO MKIII EVO FB NON-AD SOLAR	DRAWING NO: 11594		REV: A.0	
		CHECKED: -	DATE:		PART.DWG		SHEET: 5 OF 5	
CAD GENERATED DRAWING DO NOT MANUALLY UPDATE  DO NOT SCALE DRAWING		ENG:	DATE:	MATERIAL:	FINISH:	SIZE: A3	SCALE: 1:40	

ADSHEL  
level 11, 205 pacific hwy  
st leonards nsw 2065  
t: +61 (0) 2 84257200 f: +61 (0) 2 84257222



## Appendix D

# Bus Shelter Location Drawings



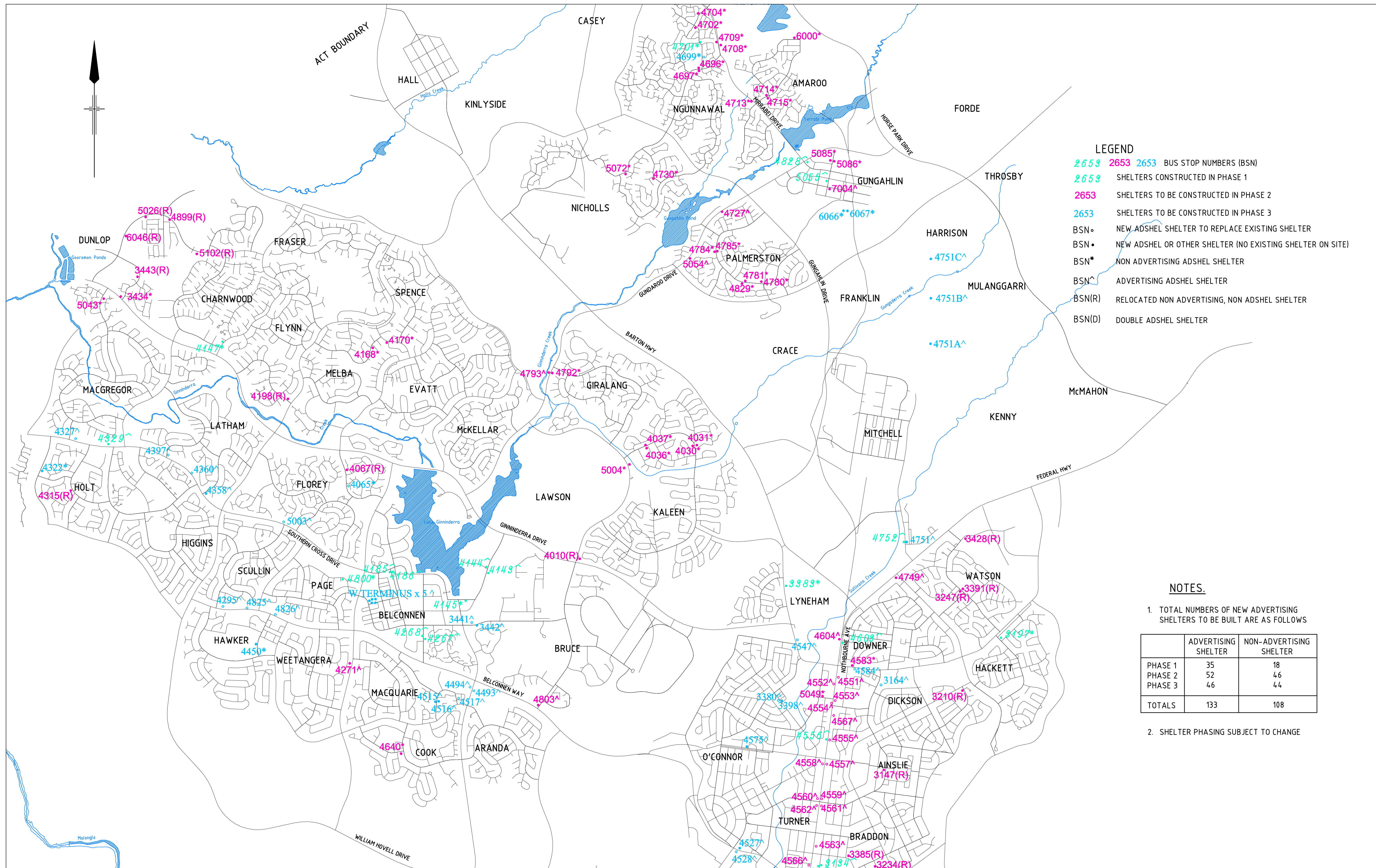

E	MASTER PLAN REV 4	RL	GG	GV	29.07.09
D	MASTER PLAN rev 3	RL	GG	PE	29.08.08
C	MASTER PLAN rev 2	RL	GG	TC	26.03.08
B	GENERAL REVISIONS	SOK			
No	Revision      Note: * indicates signatures on original issue of drawing or last revision of drawing	Drawn	Checked	Approved	Date

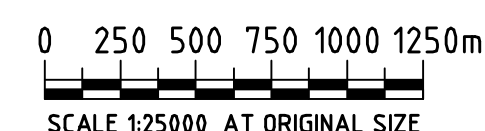

Level 7, 16 Marcus Clarke Street  
Canberra ACT 2601 Australia  
GPO Box 1877 Canberra ACT 2601  
T 61 2 6113 3200 F 61 2 6113 3299  
E [cbmail@ghd.com.au](mailto:cbmail@ghd.com.au) W [www.ghd.com.au](http://www.ghd.com.au)

DO NOT SCALE

**Conditions of Use.**  
This document may only be used by GHD's client (and any other person who GHD has agreed can use this document) for the purpose for which it was prepared and must not be used by any other person or for any other purpose.

Drawn RL	Designed GG
Drafting Check	Design Check
Approved	
Date	
Scale AS SHOWN	This Drawing must not be used for Construction unless signed as Approved.

Client	<b>ROADS ACT</b>
Project	<b>AD AND NON AD BUS SHELTERS IN THE ACT</b>
Title	<b>PROPOSED BUS SHELTER LOCATIONS SHEET 1 OF 3</b>

Original Size **A1** Drawing No: **23-13011-C001**

Rev: E



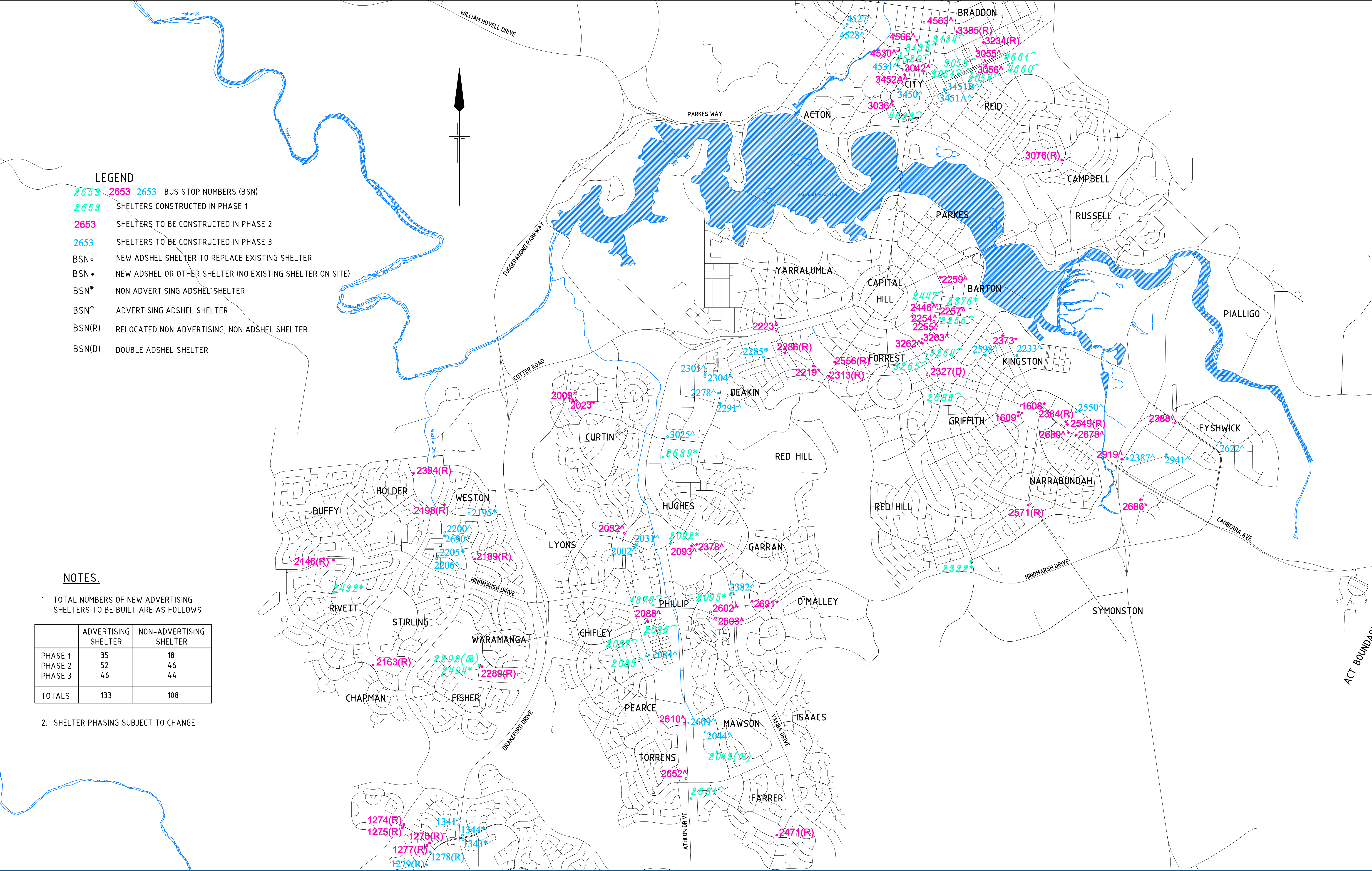

- LEGEND**
- 2653 2653 2653 BUS STOP NUMBERS (BSN)
  - 2653 SHELTERS CONSTRUCTED IN PHASE 1
  - 2653 SHELTERS TO BE CONSTRUCTED IN PHASE 2
  - 2653 SHELTERS TO BE CONSTRUCTED IN PHASE 3
  - BSN° NEW ADSHEL SHELTER TO REPLACE EXISTING SHELTER
  - BSN• NEW ADSHEL OR OTHER SHELTER (NO EXISTING SHELTER ON SITE)
  - BSN\* NON ADVERTISING ADSHEL SHELTER
  - BSN^ ADVERTISING ADSHEL SHELTER
  - BSN(R) RELOCATED NON ADVERTISING, NON ADSHEL SHELTER
  - BSN(D) DOUBLE ADSHEL SHELTER

- NOTES.**
1. TOTAL NUMBERS OF NEW ADVERTISING SHELTERS TO BE BUILT ARE AS FOLLOWS
- |         | ADVERTISING SHELTER | NON-ADVERTISING SHELTER |
|---------|---------------------|-------------------------|
| PHASE 1 | 35                  | 18                      |
| PHASE 2 | 52                  | 46                      |
| PHASE 3 | 46                  | 44                      |
| TOTALS  | 133                 | 108                     |
2. SHELTER PHASING SUBJECT TO CHANGE

E MASTER PLAN REV 4		RL	GG	GV	29.07.09	 <b>GHD</b> CLIENTS   PEOPLE   PERFORMANCE Level 7, 16 Marcus Clarke Street Canberra ACT 2601 Australia GPO Box 1877 Canberra ACT 2601 T 61 2 6113 3200 F 61 2 6113 3299 E cbmail@ghd.com.au W www.ghd.com.au	<b>DO NOT SCALE</b>		Drawn RL	Designed GG	Client	<b>ROADS ACT AD AND NON AD BUS SHELTERS IN THE ACT PROPOSED BUS SHELTER LOCATIONS SHEET 2 OF 3</b>	
D MASTER PLAN rev 3		RL	GG	PE	29.08.08		Drafting Check	Design Check	Project				
C MASTER PLAN rev 2		RL	GG	TC	26.03.08		Approved		Title				
B GENERAL REVISIONS		SOK					Date						
No	Revision	Note: * indicates signatures on original issue of drawing or last revision of drawing	Drawn	Checked	Approved	Date	Scale AS SHOWN		This Drawing must not be used for Construction unless signed as Approved		Original Size	Drawing No: <b>23-13011-C002</b>	Rev: <b>E</b>



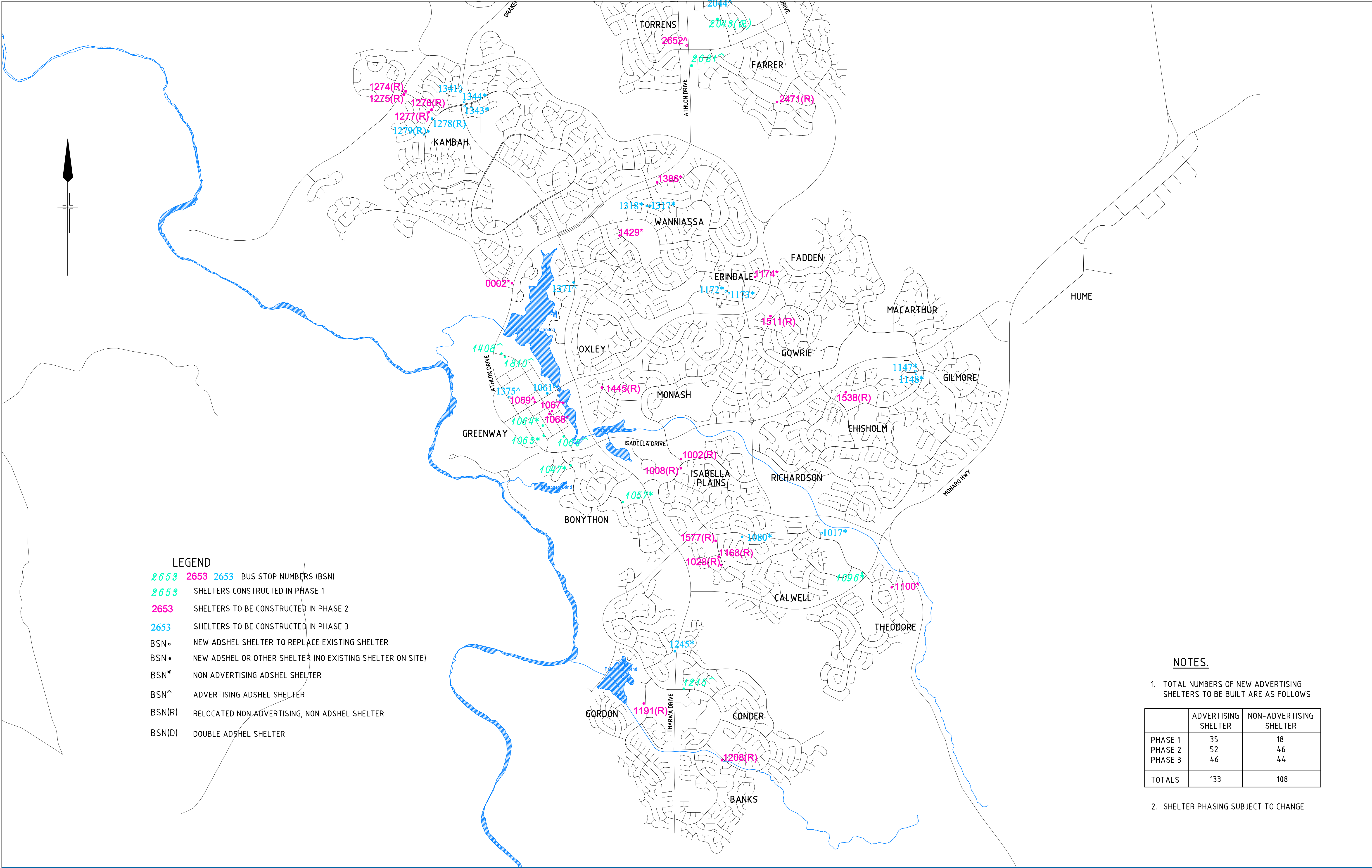

<div><div><div>E</div><div>MASTER PLAN REV 4</div></div><div><div>D</div><div>MASTER PLAN REV 3</div></div><div><div>C</div><div>MASTER PLAN REV 2</div></div><div><div>B</div><div>GENERAL REVISIONS</div></div></div> <div><div>No</div><div>Revision</div><div>Note: * indicates signatures on original issue of drawing or last revision of drawing</div></div>					<div><div>RL</div><div>GG</div><div>GV</div><div>29.07.09</div></div> <div><div>RL</div><div>GG</div><div>PE</div><div>29.08.08</div></div> <div><div>RL</div><div>GG</div><div>TC</div><div>26.03.08</div></div> <div><div>SOK</div><div></div><div></div><div></div></div>				<div><div>025050075010001250m</div><div>SCALE 1:25000 AT ORIGINAL SIZE</div></div>		<div><div><div><div>GHD</div></div><div>CLIENTS   PEOPLE   PERFORMANCE</div></div><div><div>Level 7, 16 Marcus Clarke Street</div><div>Canberra ACT 2601 Australia</div><div>GPO Box 1877 Canberra ACT 2601</div><div>T 61 2 6113 3200 F 61 2 6113 3299</div><div>E cbmail@ghd.com.au W www.ghd.com.au</div></div></div>		<div><div>DO NOT SCALE</div><div>Conditions of Use. This document may only be used by GHD's client (and any other person who GHD has agreed can use this document) for the purpose for which it was prepared and must not be used by any other person or for any other purpose.</div></div>		<div><div><div>Drawn</div><div>RL</div></div><div><div>Designed</div><div>GG</div></div></div> <div><div><div>Drafting</div><div>Check</div></div><div><div>Design</div><div>Check</div></div></div> <div><div><div>Approved</div><div>Date</div></div><div><div>Scale</div><div>AS SHOWN</div></div></div> <div><div>This Drawing must not be used for Construction unless signed as Approved</div></div>		<div><div>Client</div><div>Project</div><div>Title</div></div> <div><div>Original Size</div><div>A1</div></div> <div><div>Drawing No:</div><div>23-13011-C003</div></div> <div><div>Rev:</div><div>E</div></div>	
---	--	--	--	--	--	--	--	--	--	--	--	--	---	--	--	--	--	--



## GHD

16 Marcus Clarke St Canberra ACT 2601  
PO Box 1877 Canberra ACT 2601 Australia  
T: 61 2 6113 3200 F: 61 2 6113 3299 E: cbrmail@ghd.com.au

## © GHD 2009

This document is and shall remain the property of GHD. The document may only be used for the purpose for which it was commissioned and in accordance with the Terms of Engagement for the commission. Unauthorised use of this document in any form whatsoever is prohibited.

## Document Status

Rev No.	Author	Reviewer		Approved for Issue		
		Name	Signature	Name	Signature	Date
0	G Gardner					
1	G Gardner	T Chapman	TC	T Chapman	TC	7/3/07
2	R Latimer	G Gardner	GG	T Chapman	TC	26/3/08
3	R Latimer	G Gardner	GG	C Allard	CA	29/8/08
4	R Latimer	G Gardner		G Vernon		29/07/09