

Australian Capital Territory

Public Roads (Crace) Declaration 2013 (No 2)

R15/13

Notifiable Instrument NI2013-188

made under the

**Public Roads Act 1902, section 18 (Lands reserved as roads may be
declared public roads)**

I declare that the land described below shall be public roads.

Bill Hirst
Surveyor-General of the ACT
Delegate of the Minister

22 April 2013

The land adjacent to Sections 2, 65, 66, 71, 72 and 74 to 76 in the Division of Crace, in the District of Gungahlin, shown in thick black lines on the plan annexed hereto.

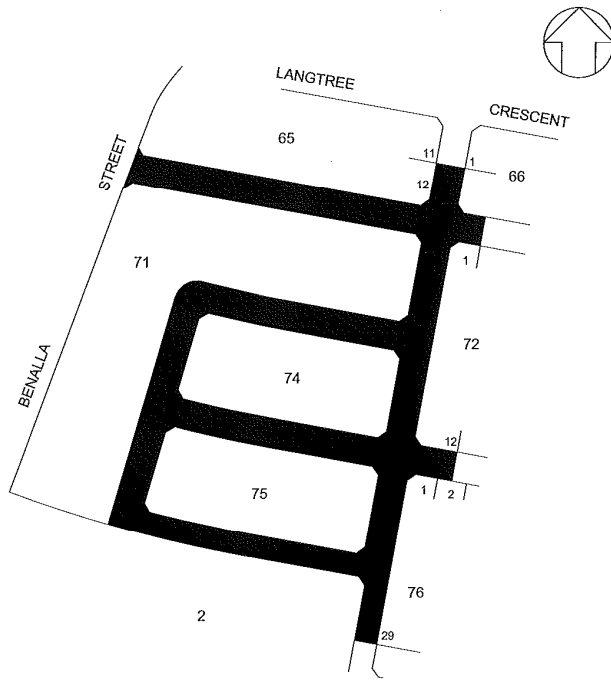

■ ROAD OPENING

DIVISION OF CRACE

This is the plan annexed to Public Roads (Crace) Declaration 2013 (No 2) signed on
 this 22nd day of April 2013.

HL

 Delegate's Initials